

Instructions and Parts List

AccuGlide™

STD (Upper)

and

STD (Lower)

Taping Heads Model 18500

IMPORTANT
It is recommended you immediately order the spare parts listed on page 17. These parts are expected to wear through normal use, and should be kept on hand to minimize production delays.

3M Packaging Systems Division

3M Center Bldg. 220-8W-01
St. Paul, MN 55144-1000



Service Instructions

To Our Customers:

This is the "3M-Matic"/"AccuGlide"/"Scotch"/"Opta-Pak" brand Equipment you ordered. It has been set up and tested in the factory with "Scotch" Brand tapes. If any problems occur when operating this equipment, and you desire a service call, or phone consultation, call the 3M National Service Center on 1-800/328 1390 (Twin Cities Metro Area call 731 6507). Please provide the customer support coordinator with the machine number and serial number. If you have a technical question that does not require an immediate response, you may Fax it to 612/731 6650.

Replacement Parts

Order parts by part number, part name, quantity required, machine name, number and type number.

Replacement parts and parts prices available from:

Dispenser Parts
Route 4, Box 5B
Amery, WI 54001
715/268 8126 (WI)
800/344 9883 (Outside WI)
FAX# 715/268 8153

Instruction Manual
STD Taping Head (Upper)
STD Taping Head (Lower)

Table of Content							Page
Equipment Warranty and Limited Remedy	-	-	-	-	-	-	ii
Description	-	-	-	-	-	-	1
Receiving and Handling	-	-	-	-	-	-	2
Taping Head Contents	-	-	-	-	-	-	2
Specifications	-	-	-	-	-	-	3
Assembly and Installation Procedure	-	-	-	-	-	-	4 - 11
2A	-	-	-	-	-	-	4 - 5
8A	-	-	-	-	-	-	6
1AF	-	-	-	-	-	-	7
16AF	-	-	-	-	-	-	8 - 9
Other Standard or Custom Machinery	-	-	-	-	-	-	11
Set-Up Procedure	-	-	-	-	-	-	11 - 13
Adjustments	-	-	-	-	-	-	14 - 15
Maintenance	-	-	-	-	-	-	15 - 16
Suggested Spare Parts	-	-	-	-	-	-	17
How to Order Replacement Parts	-	-	-	-	-	-	17
Repair Service	-	-	-	-	-	-	17
Replacement Parts Illustrations and Parts Lists	-	-	-	-	-	-	Yellow Section

Equipment Warranty and Limited Remedy: THE FOLLOWING WARRANTY IS MADE IN LIEU OF ALL OTHER WARRANTIES, EXPRESS OR IMPLIED, INCLUDING, BUT NOT LIMITED TO, THE IMPLIED WARRANTY OF MERCHANTABILITY, THE IMPLIED WARRANTY OF FITNESS FOR A PARTICULAR PURPOSE AND ANY IMPLIED WARRANTY ARISING OUT OF A COURSE OF DEALING, A CUSTOM OR USAGE OF TRADE:

3M Sells its AccuGlide™ STD (Upper and Lower) Taping Heads, Model 18500 with the following warranties:

1. The Taping Head knife blades, springs and rollers will be free from all defects for ninety (90) days after delivery.
2. All other Taping Head parts will be free from all defects for three (3) years after delivery.

If any part is proved to be defective within its warranty period, then the exclusive remedy and 3M's and seller's sole obligation shall be, at 3M's option, to repair or replace the part, provided the defective part is returned immediately to 3M's factory or an authorized service station designated by 3M. A part will be presumed to have become defective after its warranty period unless the part is received or 3M is notified of the problem no later than five (5) calendar days after the warranty period. If 3M is unable to repair or replace the part within a reasonable time, then 3M, at its option, will replace the equipment or refund the purchase price. 3M shall have no obligation to provide or pay for the labor required to install the repaired or replacement part. 3M shall have no obligation to repair or replace (1) those parts failing due to operator misuse, carelessness, or due to any accidental cause other than equipment failure, or (2) parts failing due to non-lubrication, inadequate cleaning, improper operating environment, improper utilities, or operator error.

Limitation of Liability: 3M and seller shall not be liable for direct, indirect, special, incidental or consequential damages based upon breach of warranty, breach of contract, negligence, strict liability or any other legal theory.

The foregoing Equipment Warranty and Limited Remedy and Limitation of Liability may be changed only by a written agreement signed by authorized officers of 3M and seller.

"Scotch", "3M-Matic" and "AccuGlide" are trademarks of 3M, St. Paul, Minnesota 55144-1000.

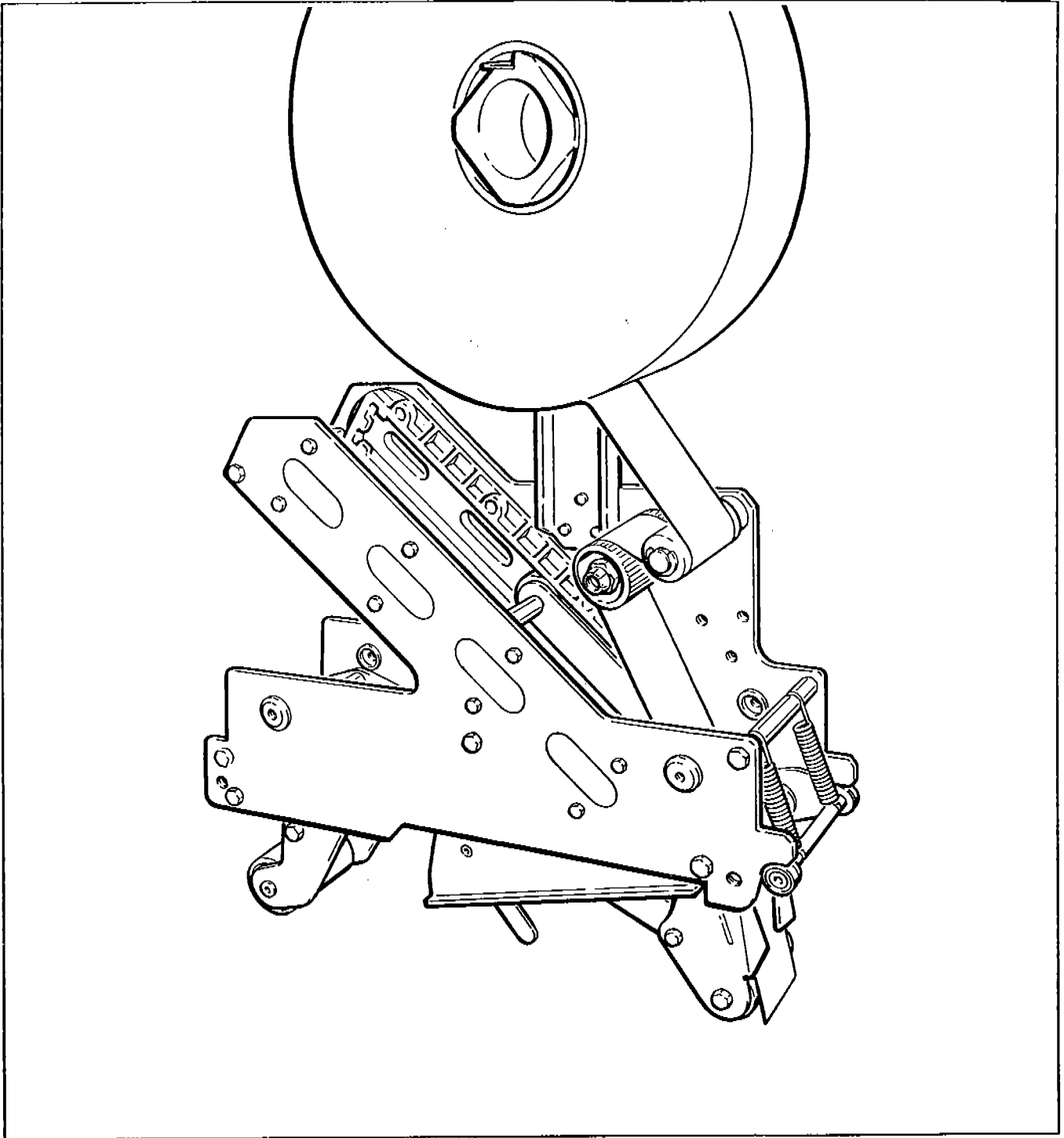

"AccuGlide" STD Taping Head (Upper), Model 18500

Description

The "AccuGlide" STD Taping Heads, (Upper and Lower) were designed for installation on "3M-Matic" Case Sealers. Both taping heads apply a "C" clip of "Scotch" Brand Pressure-sensitive Film Box Sealing Tape to the top and bottom center seam of regular slotted containers. The compact size and simplicity of the taping head also makes it suitable for mounting into other box conveying systems to tape cartons. This includes replacement of other types of taping, gluing or stapling heads in existing case sealing machines.

Receiving And Handling

After the taping head assembly has been unpackaged, examine the unit for damage that might have occurred during transit. If damage is evident, file a damage claim immediately with the transportation company and also your 3M Representative.

Taping Head Contents

STD Taping Head (Upper)

For Use On "3M-Matic" case sealers 1AF, 2A, 8A, 12A, 12AF, 12AFLM, 12RF, 16AF, 22A, 22ALM, 77A, 77ALM, 77R, 77RLM.

Consists Of:

Qty.	Part Name
1	Taping Head Assembly
1	Tape Drum and Bracket Assembly
1	Hardware and Spare Parts Kit
1	Threading Tool

STD Taping Head (Lower)

For Use On "3M-Matic" case sealers 1AF, 2A, 8A, 8AB, 12A, 12AB, 12AF, 12AFLM, 12RF, 16AF 22A, 22ALM, 77A, 77ALM, 77R, 77RLM.

Consists Of:

Qty.	Part Name
1	Taping Head Assembly
1	Tape Drum and Bracket Assembly
1	Hardware and Spare Parts Kit
1	Threading Tool

Specifications

The specifications below apply to all the upper and lower heads except where noted.

1. Tape:

For use with "Scotch" brand pressure-sensitive film box sealing tapes.

2. Tape Width:

1 1/2 inches or 36 mm minimum to 2 inches [50 mm] maximum.

3. Tape Roll Diameter:

Up to 15 1/2 inches [395 mm] maximum on a 3 inch [76,2 mm] diameter core. (Accommodates all system roll lengths of "Scotch" brand film tapes.)

4. Tape Application Leg Length:

2 3/4 inches \pm 1/4 inch [70 mm \pm 6 mm]

5. Box Size Capacities:

For use with center seam regular slotted containers.

Minimum	Maximum
Length - 6 inches [150 mm]	Unlimited
Height - 5 3/4 inches [145 mm] (2A, 8A, 16AF)	Unlimited
6 3/4 inches [170 mm] (1AF)	Unlimited
4 3/4 inches [120 mm] (Most "3M-Matic" Case Sealers)	Unlimited
Width - 6 inches [150 mm]	Unlimited

When upper and lower taping heads are used on "3M-Matic" case sealers, refer to the respective instruction manual specifications for box weight and size capacities.

6. Operating Conditions:

Use in dry, relatively clean environments at 40° to 105° F [5° to 40° C] with clean, dry boxes.

IMPORTANT SAFEGUARD

Taping heads should not be washed down or subjected to conditions causing moisture condensation on components.

7. Taping Head Dimensions:

- A. Length - 16 1/2 inches [420 mm]
- B. Height - 21 3/4 inches [550 mm]
- C. Width - 3 7/8 inches [100 mm] - without mounting spacers
- D. Weight - Packaged: 18 lbs. [8,2 kg]
Unpackaged: 16 lbs. [7,2 kg]

Assembly Procedure

IMPORTANT SAFEGUARDS

1. BOTH THE UPPER AND LOWER TAPING HEADS UTILIZE EXTREMELY SHARP KNIFE BLADES ON THE ORANGE CUTTER LEVER ASSEMBLY AND WHICH ARE LOCATED UNDER THE BLADE GUARD WHICH HAS THE "WARNING - SHARP KNIFE" LABEL. BEFORE WORKING WITH THE TAPING HEADS OR ATTEMPTING TO LOAD THE TAPE, REFER TO FIGURES 12 AND 12A AND IDENTIFY THE BLADE LOCATION. KEEP HANDS OUT OF THESE AREAS EXCEPT AS NECESSARY TO SERVICE THE TAPING HEADS.
2. NEVER ATTEMPT TO WORK ON THE TAPING HEADS OR LOAD TAPE WHEN THE BOX DRIVE BELTS ARE RUNNING.

The taping head can be used in existing 2A, 8A, 1AF and 16AF standard "3M-Matic" case sealers. Refer to the desired case sealer and follow the assembly and installation procedures.

2A Case Sealer Upper Taping Head

1. Assemble the tape drum bracket assembly to the upper taping head as shown. Secure in a vertical position using the three screws provided with the hardware kit.
2. Assemble and secure the four hex spacers provided with the hardware kit.
3. Remove and retain the four screws holding the standard upper taping head in the 2A. Remove the standard head.
4. Install the new upper head with the applying roller toward the infeed end. Secure in position with the four existing screws.

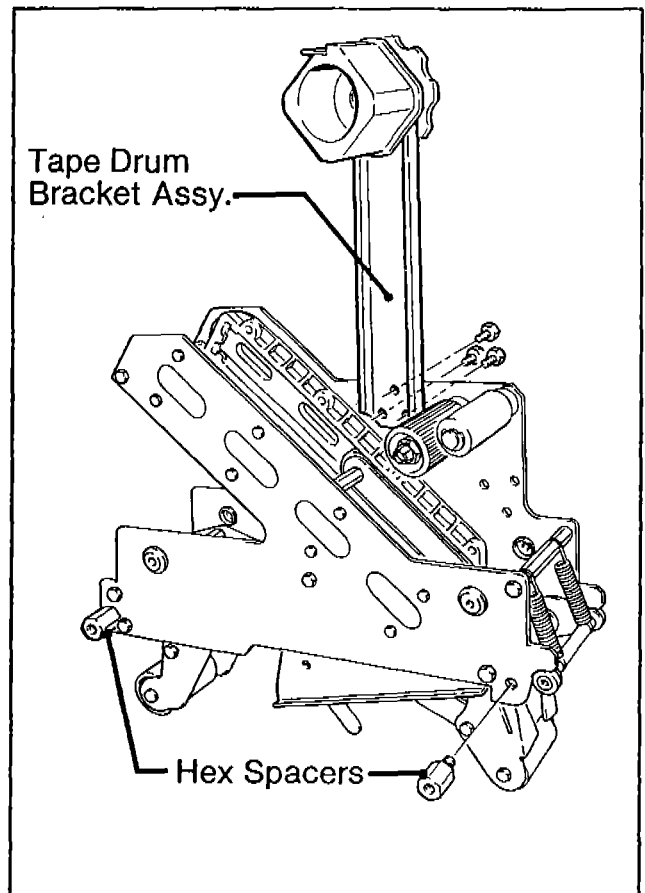

Figure 1 - Upper Taping Head

Assembly Procedure (Continued)

Lower Taping Head - Refer to Figure 2

1. Assemble the tape drum bracket assembly to the lower taping head as shown. Secure in a vertical position using the three screws provided with the hardware kit.
2. Assemble and secure the four round spacers (large) provided with the hardware kit.

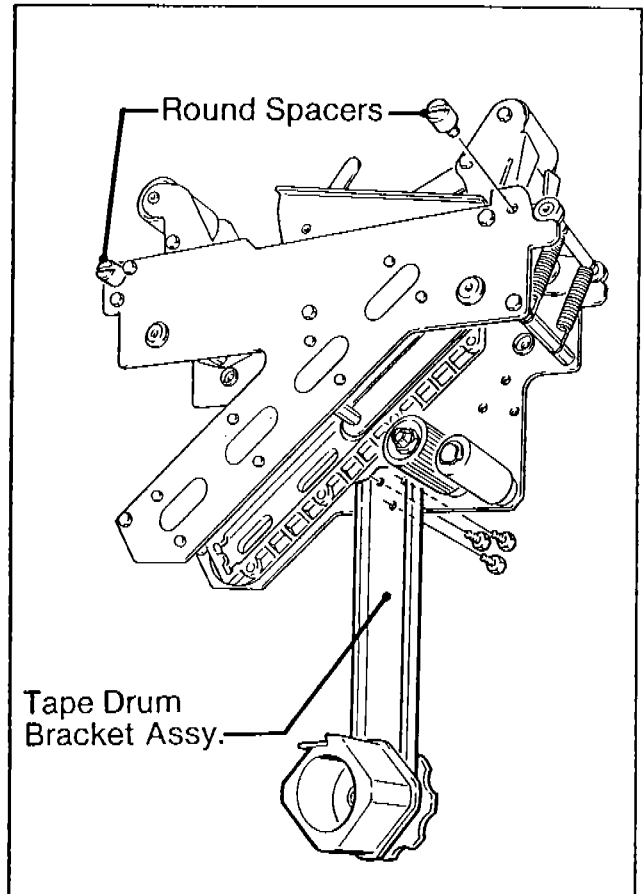

Figure 2 - Lower Taping Head

3. Remove the standard lower taping head from the 2A bed frame.
4. Remove and retain the four screws to remove the two rear mounting brackets (single slot) from the bed frame.
5. Install the two new mounting brackets (double slots) provided with the hardware kit. Secure as shown with the four existing screws.
6. Install the new lower head with the applying roller toward the infeed end.

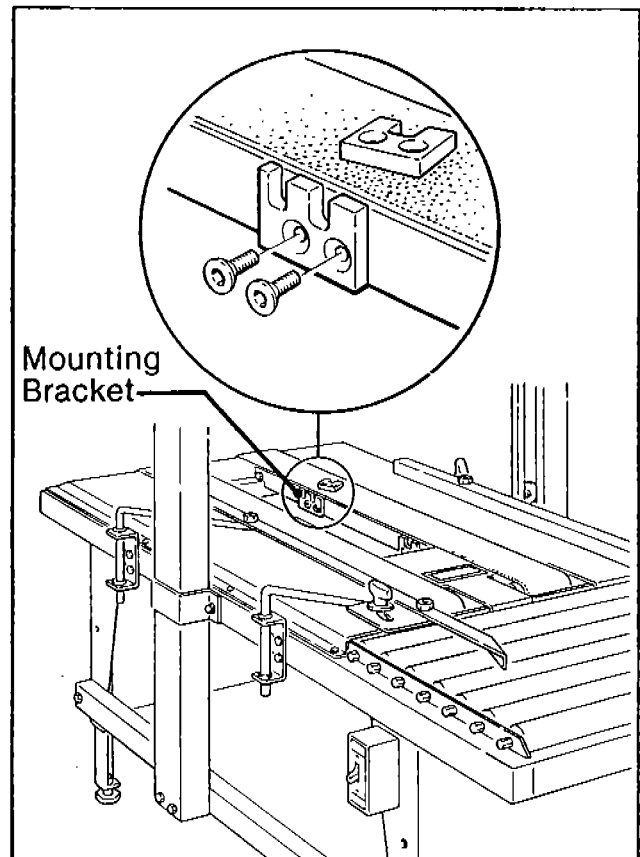

Figure 3 - Rear Mounting Brackets

Assembly Procedure (Continued)

8A Case Sealer

Upper Taping Head - Refer to Figure 4

1. Assemble the tape drum bracket assembly to the upper taping head as shown. Secure in a vertical position using the three screws provided with the hardware kit.
2. Assemble and secure the four hex spacers provided with the hardware kit.
3. Remove and retain the four screws holding the standard upper taping head in the 8A. Remove the standard head.
4. Install the new upper head with the applying roller toward the infeed end. Secure in position with the four existing screws.

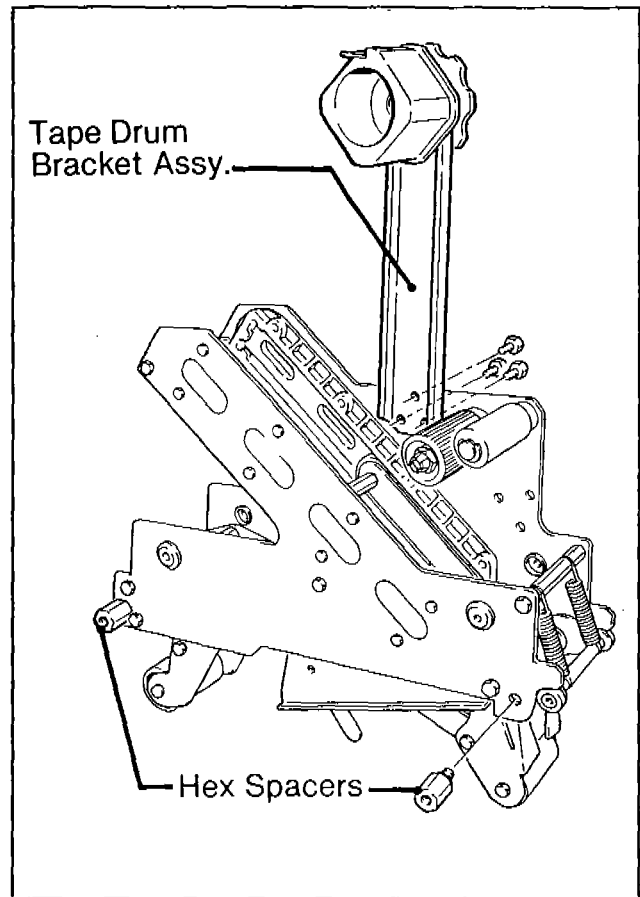

Figure 4 - Upper Taping Head

Lower Taping Head - Refer to Figure 5

1. Assemble the tape drum bracket assembly to the lower taping head as shown. Secure in a vertical position using the three screws provided with the hardware kit.
2. Assemble and secure the four hex spacers provided with the hardware kit.
3. Assemble and secure the four mounting screws (small) into the hex spacers as shown.
4. Remove the standard lower taping head from the 8A bed frame.
5. Install the new lower head in the bed with the applying roller toward the infeed end.

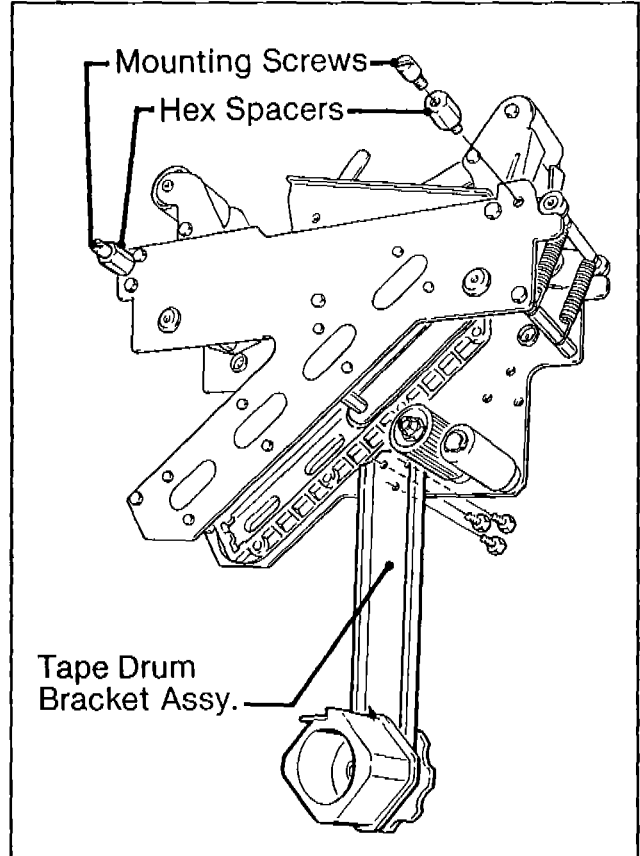

Figure 5 - Lower Taping Head

Assembly Procedure (Continued)

1AF Case Sealer

Upper Taping Head - Refer to Figure 6

1. Assemble the tape drum bracket assembly to the upper taping head as shown. Secure in a vertical position using the three screws provided with hardware kit.
2. Assemble and secure the four hex spacers provided with the hardware kit.
3. Remove and retain the four screws holding the standard upper taping head in the 1AF. Remove the standard head.
4. Install the new upper head with the applying roller toward the infeed end. Secure in position with the four existing screws.

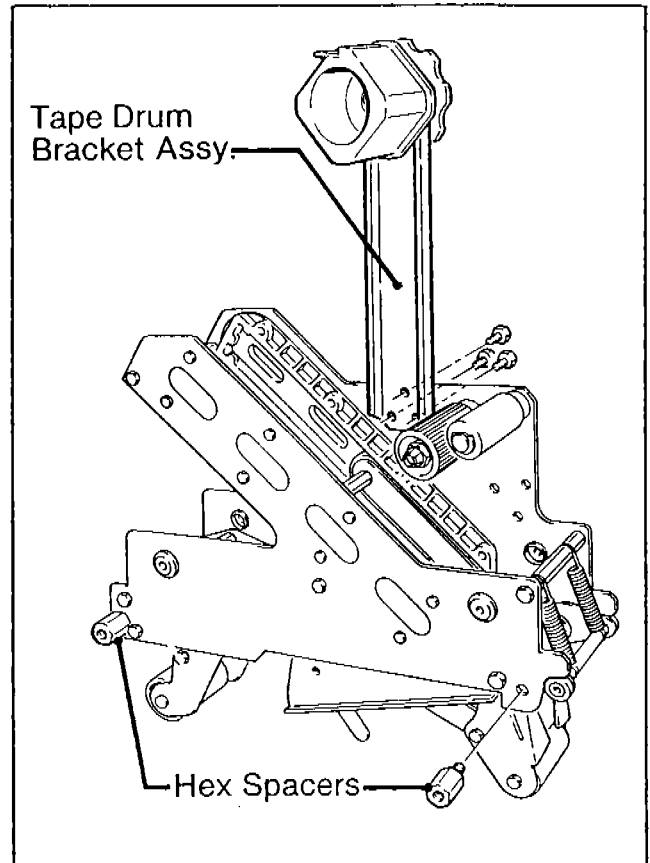

Figure 6 - Upper Taping Head

Lower Taping Head - Refer to Figure 7

1. Assemble the tape drum bracket assembly to the lower taping head as shown. Secure the bracket using the three screws provided with the hardware kit.
2. Assemble and secure the four hex spacers provided with the hardware kit.
3. Assemble and secure the four mounting screws (small) into the hex spacers as shown.
4. Remove the standard lower taping head from the 1AF bed frame.
5. Install the new lower head with the applying roller toward the infeed end.

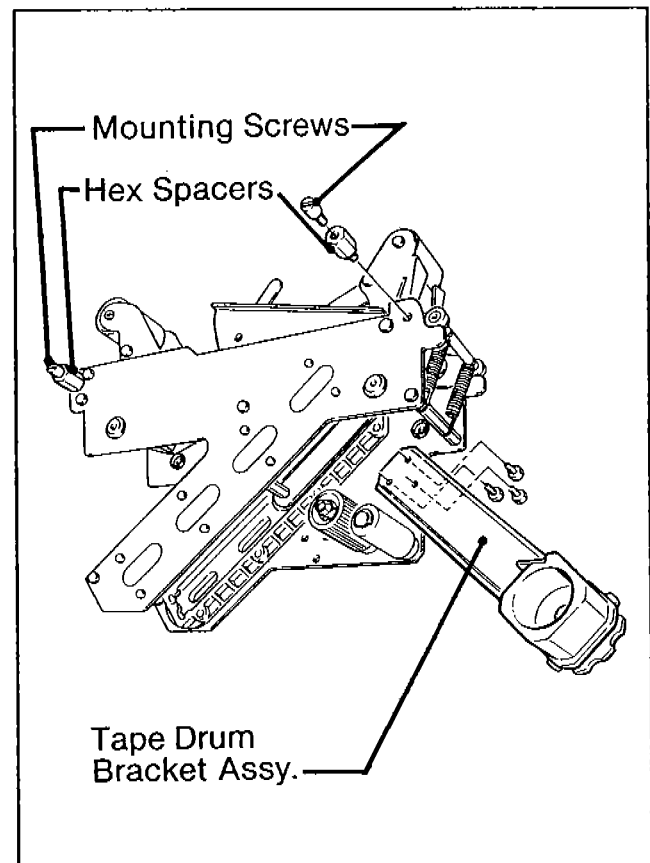

Figure 7 - Lower Taping Head

Assembly Procedure (Continued)

16AF Case Sealer

Upper Taping Head - Refer to Figure 8

1. Assemble the tape drum bracket assembly slanted to the rear of the upper taping head as shown. Secure in position shown, using the three screws provided with the hardware kit.
2. Assemble and secure the four hex spacers provided with the hardware kit.
3. Remove and retain the four screws holding the standard upper taping head in the 16AF. Remove standard head.

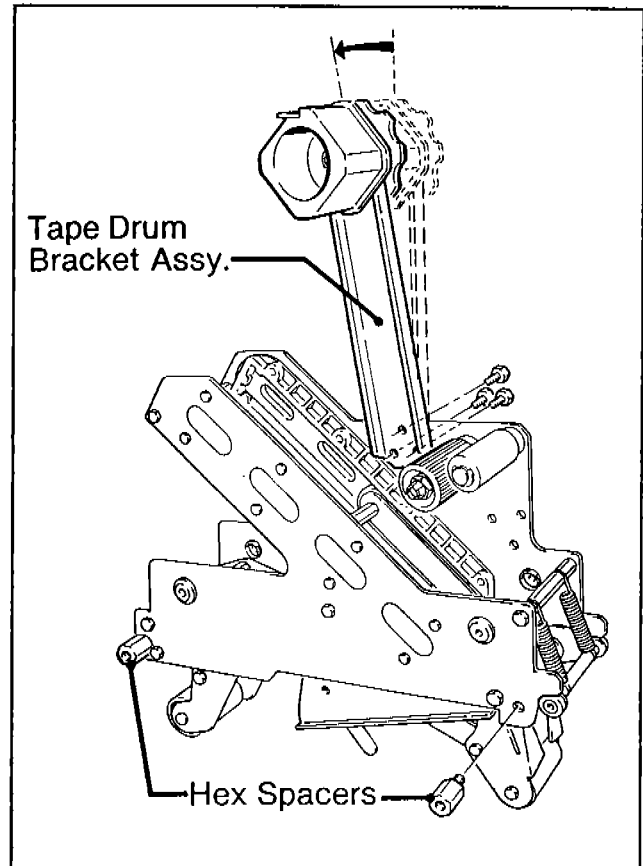

Figure 8 - Upper Taping Head

Flap Guide Modification - Refer to Figure 9

4. Remove and retain a screw and nut to remove the flap guide from the 16AF frame as shown.
5. Remove 2 1/4 inches [60 mm] from lower ski on flap guide as shown.
6. Assemble and secure modified flap guide using existing screw and nut.
7. Install the new upper head with the applying roller toward the infeed end. Secure in position with the four existing screws.

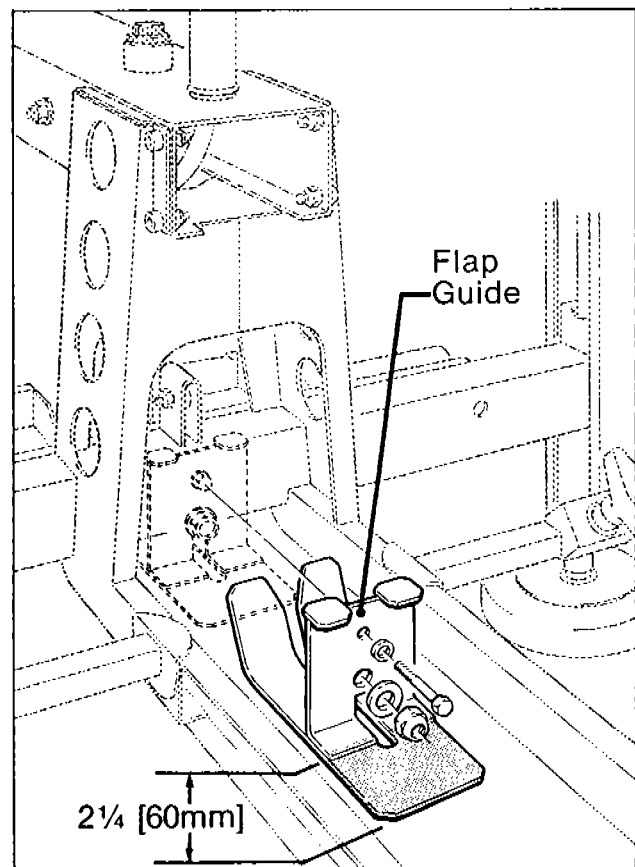

Figure 9 - Flap Guide Modification

Assembly Procedure (Continued)

Lower Taping Head - Refer to Figure 10

1. Assemble the tape drum bracket assembly to the lower taping head as shown. Secure the bracket using the three screws provided with the hardware kit.
2. Assemble and secure the four hex spacers provided with the hardware kit.
3. Assemble and secure the four mounting screws (small) into the hex spacers as shown.
4. Remove the standard lower taping head from the 16AF bed frame.
5. Install the new lower head with the applying roller toward the infeed end.

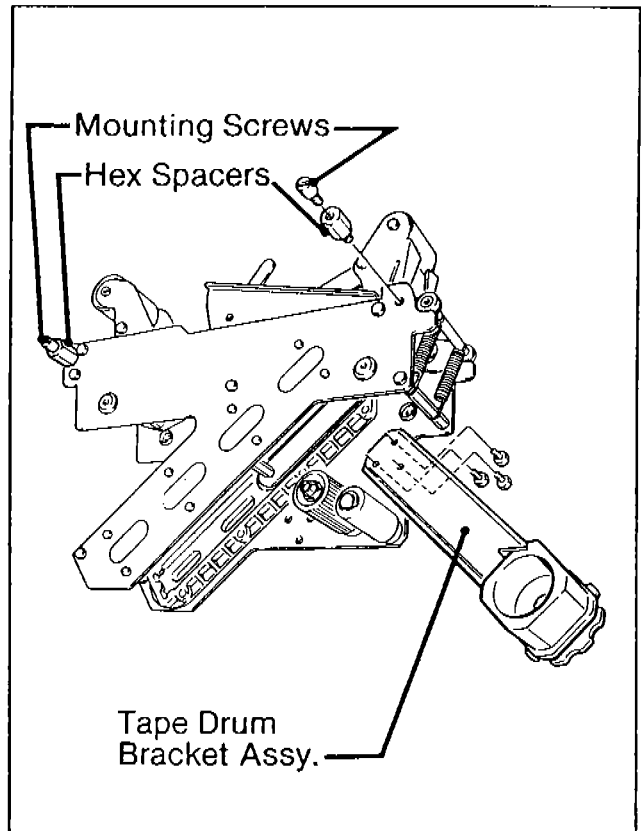

Figure 10 - Lower Taping Head

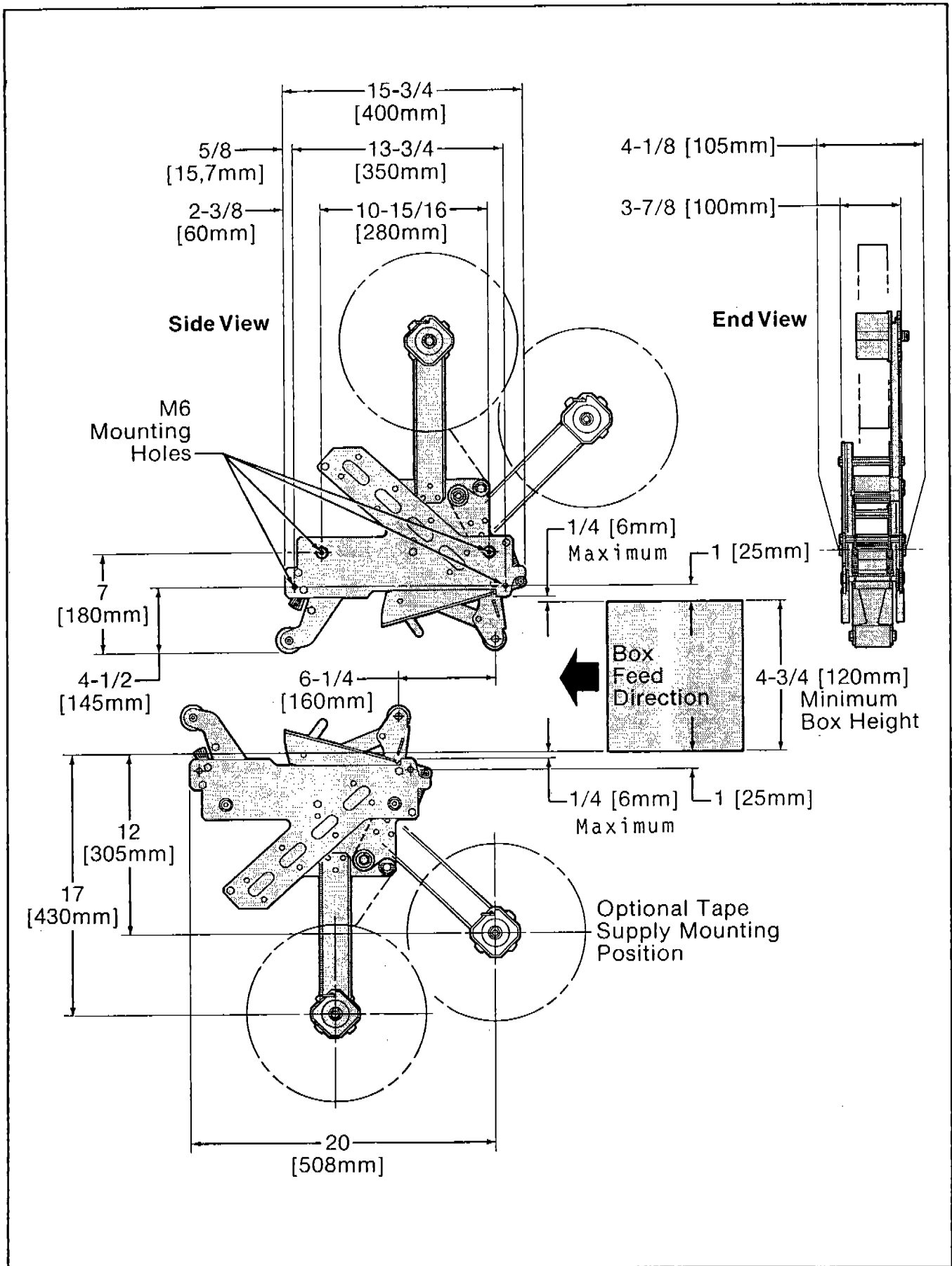

Figure 11 - Taping Head Assemblies - Typical Mounting

Installation

IMPORTANT SAFEGUARDS

BOTH THE UPPER AND LOWER TAPING HEADS UTILIZE EXTREMELY SHARP KNIFE BLADES ON THE ORANGE CUTTER LEVER ASSEMBLY AND WHICH ARE LOCATED UNDER THE BLADE GUARD WHICH HAS THE "WARNING - SHARP KNIFE" LABEL. BEFORE WORKING WITH THE TAPING HEADS OR ATTEMPTING TO LOAD THE TAPE, REFER TO FIGURES 12 AND 12A AND IDENTIFY THE BLADE LOCATION. KEEP HANDS OUT OF THESE AREAS EXCEPT AS NECESSARY TO SERVICE THE TAPING HEADS.

The taping head assembly can be used in converting existing or in custom made machinery. It can be mounted for top taping or bottom taping. Refer to box size specifications on page 3 and figure 11 on page 10, for the following points in making such installations:

1. The box conveying system must positively propel the box in a continuous motion, not exceeding 80 feet per minute, past the taping head assembly since the box motion actuates the taping mechanism.
2. If a pusher or cleated conveyor is being used, steps should be taken in the conveyor design to prevent the pusher from contacting the applying or buffing roller arms resulting in damage to the taping head.
3. Figure 11 illustrates the typical mounting relationship for opposing taping head assemblies to allow taping of box heights down to 4 3/4 inches or 120 mm. To tape box heights down to 2 3/4 inches [70 mm], the taping head assemblies must be completely staggered so only one tape seal is being applied at one time.
4. Four (4) mounting screws or spacers are provided with the taping head, but special installations may require alternate means for mounting.
5. Box hold-down or guide skis should be provided and the taping head mounted so that the side plates are 1/4 inch [6 mm] away from the ski surface on which the box rides. For example, mounting screws, if used, should be located 1 inch [25 mm] from the ski surface.
6. The upper and lower taping heads provide two mounting positions for the tape drum bracket, as shown in figure 11.

Set-Up Procedure

Tape Loading

The taping head accommodates up to 2 inch [50 mm] wide tape rolls. To apply 1 1/2 inch or 36 mm or 1 3/4 inch or 42 mm wide tapes, refer to "Adjustments" Section for set-up information.

One red plastic threading needle is provided with each taping head and it is recommended that the detailed instructions and sketches in this manual be referred to the first few times the unit is loaded and until the operator becomes thoroughly familiar with the tape loading operation.

Set-Up Procedure (Continued)

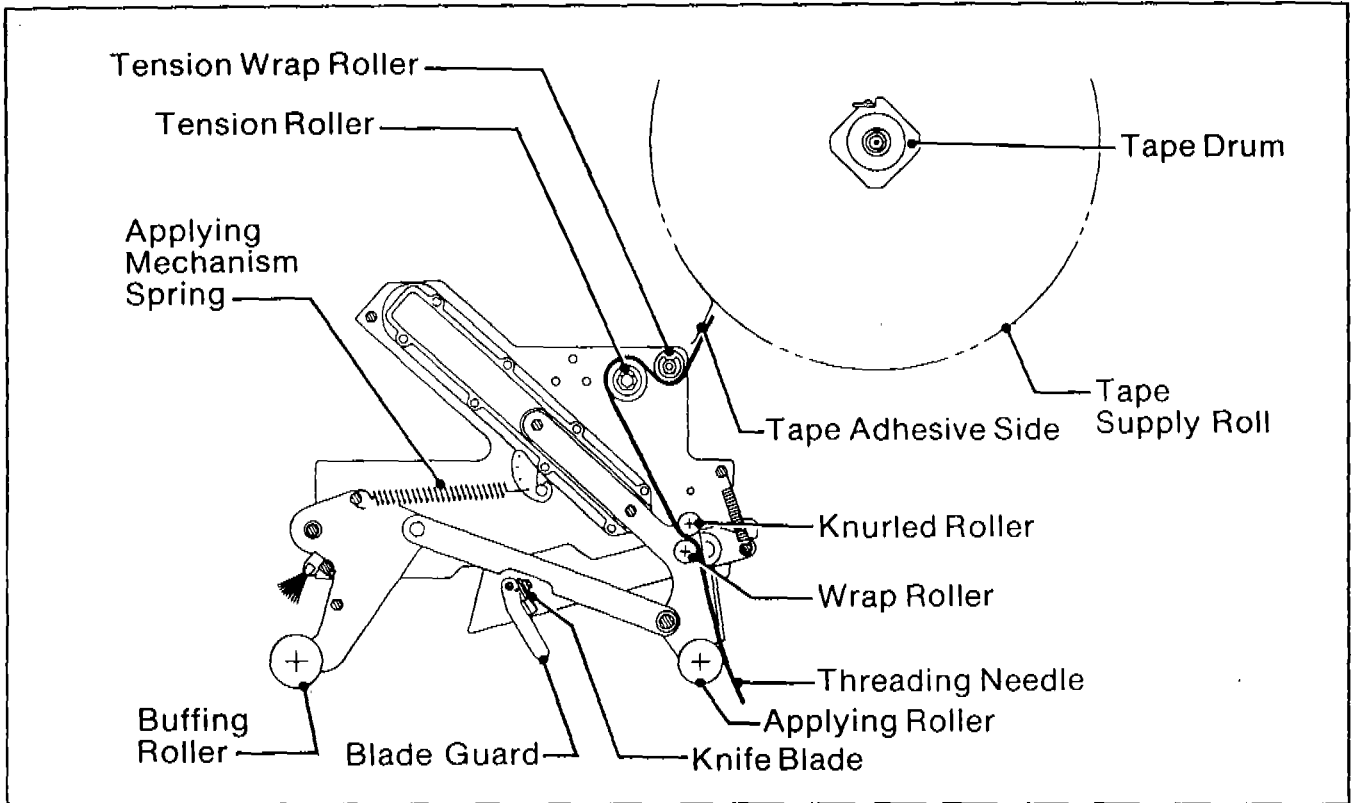

Figure 12 - Tape Threading Diagram - Upper Taping Head - Left Side View

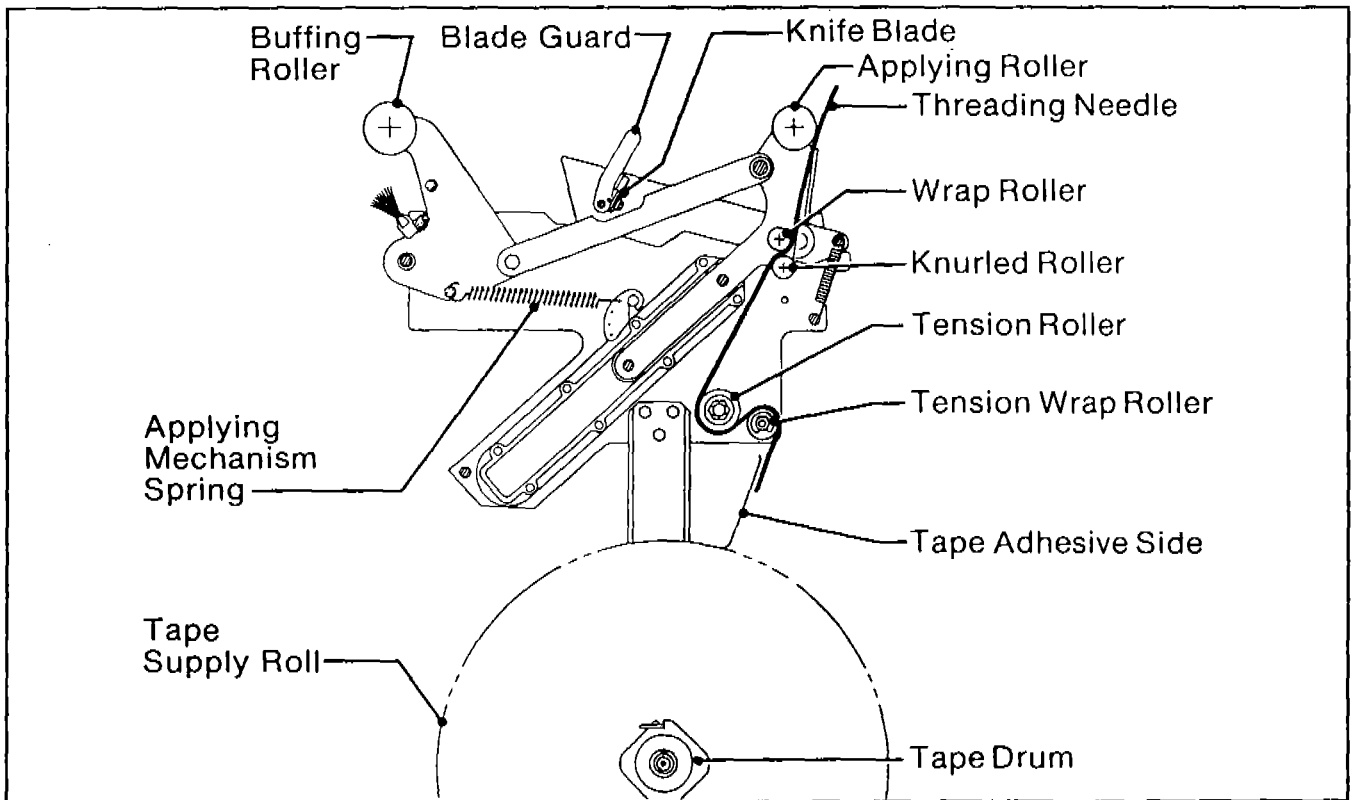

Figure 12A - Tape Threading Diagram - Lower Taping Head - Left Side View

Set-Up Procedure (Continued)

Tape Loading - Upper Taping Head

WARNING - NEVER ATTEMPT TO WORK ON THE TAPING HEADS OR LOAD TAPE WHEN THE BOX DRIVE BELTS ARE RUNNING. PERSONNEL INJURY OR EQUIPMENT DAMAGE CAN POTENTIALLY RESULT.

1. It is first necessary to raise the upper taping head to the fully raised position.
2. For subsequent tape loading operations, use the red plastic threading needle and follow the loading procedures from Figure 12B to complete the tape threading.

Tape Loading - Lower Taping Head

The lower taping head, Figure 12A, is loaded and threaded in the same manner as the upper taping head.

For ease in loading, first remove the lower taping head from the conveyor and follow the upper taping head tape loading procedure.

Figure 12B

Insert the red plastic needle downward around rollers as illustrated.

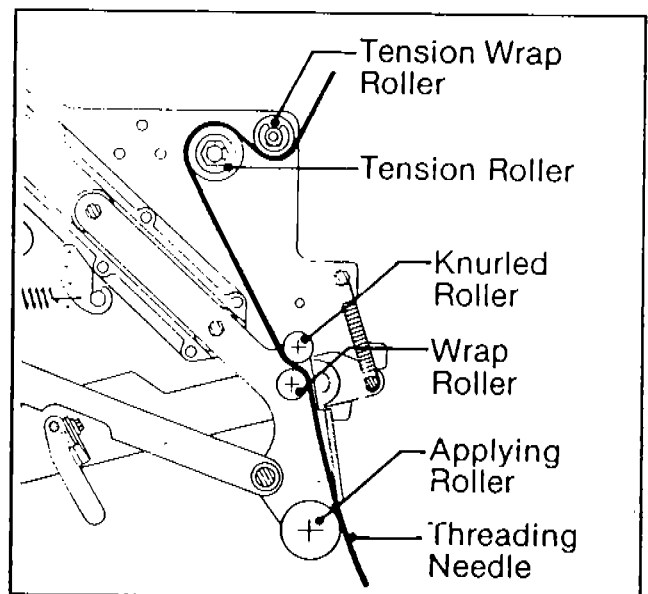

Figure 12B

Figure 12B and 12C

Place tape roll on drum to dispense tape from bottom of roll toward tension wrap roller with tape adhesive side in. Seat tape roll fully against back flange of drum. Adhere tape lead end to upper end of threading needle as shown.

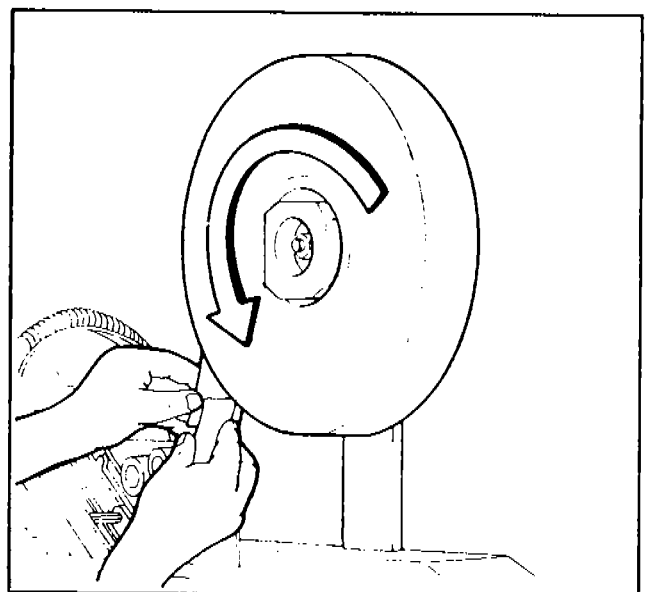

Figure 12C

Set-Up Procedure (Continued)

WARNING - USE CARE WHEN WORKING NEAR BLADES AS BLADES ARE EXTREMELY SHARP. IF CARE IS NOT TAKEN, SEVERE INJURY TO PERSONNEL COULD RESULT.

Figure 12D

Manually turn tape roll to create slack tape while pulling threading needle through tape applying mechanism until needle is through and tape is in alignment with applying roller. Excess tape can be cut with a scissors or knife at applying roller.

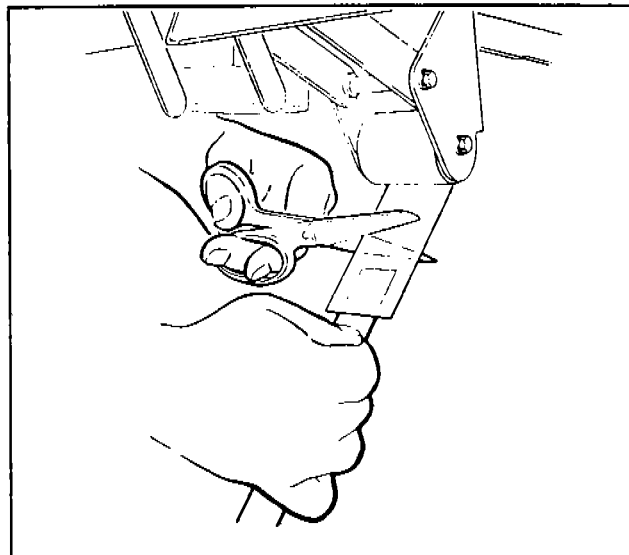

Figure 12D

Adjustments

Tape Web Alignment - Refer to Figure 13

The tape drum assembly on each taping head is pre-set to accommodate 2 inch [50 mm] wide tape, but is adjustable to provide alignment of narrower tapes. If adjustment is necessary to center the tape width on the centerline of the taping head, (and therefore box center seam), make adjustment as follows:

1. Loosen hand knob behind tape drum on tape drum shaft.
2. Turn tape drum shaft in or out to center the tape web.
3. Tighten hand knob to secure the adjustment.

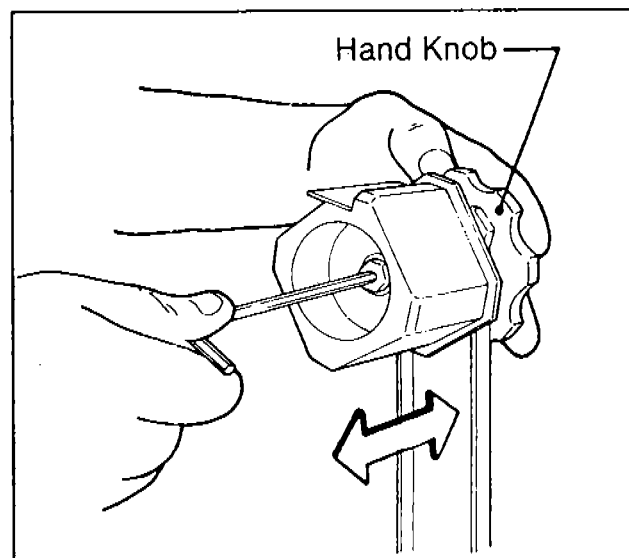

Figure 13

No other components require adjustment for tape web alignment.

Applying Mechanism Spring

The applying mechanism spring, shown in Figure 12, controls applying and buffering roller pressure on the box and returns the mechanism to the reset position. The spring pressure is pre-set, as shown in Figure 14A, for normal operation but is adjustable.

Removing the spring end loop from the spring holder and placing loop in other holes provided, as shown in Figure 14B, will decrease the spring pressure.

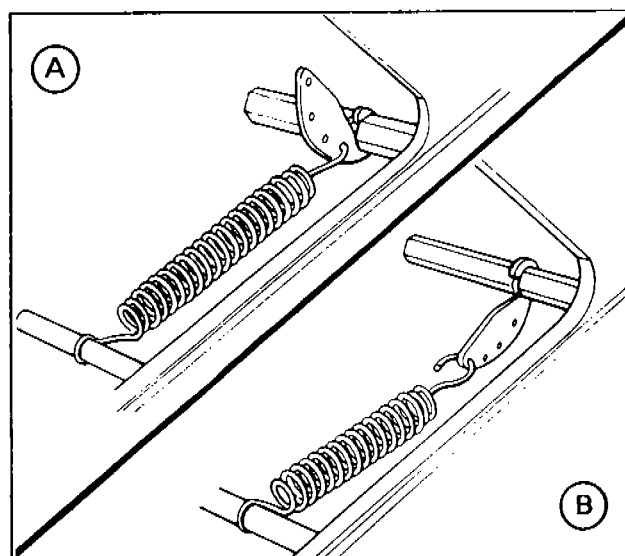

Figure 14

Adjustments (Continued)

One Way Tension Roller Assembly Figure 15

The one way tension roller is factory set. When replacing this assembly, the roller must have 1 lb. [0,5 kg] tangential force when turning.

To Set Tension

1. Wrap a cord or small strap (non-adhesive) 4-6 turns around the tension roller.
2. Attach a spring scale to the end of the cord or strap.
3. Turn the adjusting nut until a force of approximately 1 lb. [0,5 kg] is required to turn the roller by pulling on the spring scale.

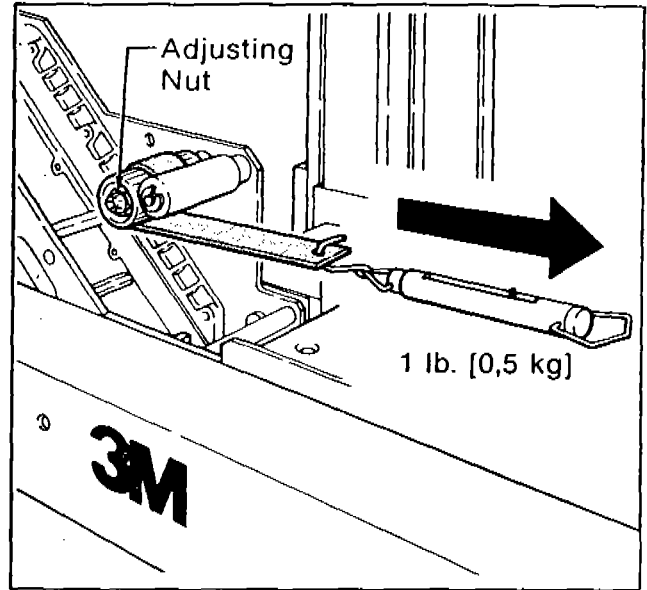

Figure 15

Maintenance

The taping head has been designed for long, trouble free service. The taping head will perform best when it receives routine maintenance and cleaning. Taping head components that fail or wear excessively should be promptly repaired or replaced to prevent damage to other portions of the head or to the product.

! WARNING - TURN OFF ELECTRICAL POWER SUPPLY AND DISCONNECT POWER CORD FROM ELECTRICAL SUPPLY BEFORE BEGINNING MAINTENANCE. IF POWER CORD IS NOT DISCONNECTED, SEVERE INJURY TO PERSONNEL COULD RESULT. USE CARE WHEN REPLACING BLADES AS BLADES ARE EXTREMELY SHARP. IF CARE IS NOT TAKEN, SEVERE INJURY TO PERSONNEL COULD RESULT.

Blade Replacement - Refer to Figure 16

1. Loosen, but do not remove, the blade screws (A). Remove and discard the old blade.
2. Mount the new blade (B) with the beveled side toward the blade holder.
3. Position the blade at an angle so all the teeth are as close as possible to the blade guard without contacting it. Tighten the blade screws to secure the blade.

NOTE - check the blade position to insure proper clearance by slowly pivoting the blade guard back.

The same steps are followed on the upper and lower taping heads. Connect the main power supply.

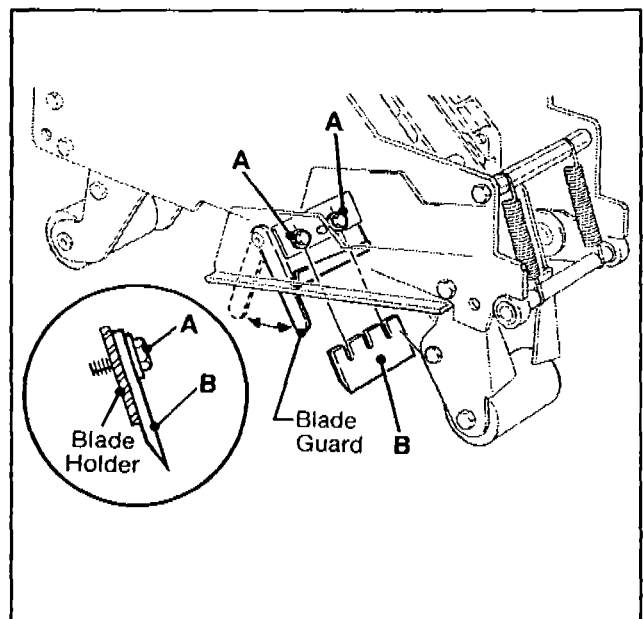

Figure 16 - Blade Replacement

Maintenance (Continued)

Cleaning Of The Taping Heads

CAUTION - NEVER ATTEMPT TO REMOVE DIRT FROM TAPING HEADS BY BLOWING IT OUT WITH COMPRESSED AIR. THIS CAN CAUSE THE DIRT TO BE BLOWN INSIDE THE COMPONENTS ONTO SLIDING SURFACES. DIRT IN THESE AREAS CAN CAUSE SERIOUS EQUIPMENT DAMAGE. NEVER WASH DOWN OR SUBJECT TAPING HEADS TO CONDITIONS CAUSING MOISTURE CONDENSATION ON COMPONENTS. SERIOUS EQUIPMENT DAMAGE COULD RESULT.

Regular slotted containers produce a great deal of dust and paper chips when conveyed through the taping heads. If this dust is allowed to build-up on the heads, it can cause wear on the moving components. Excessive dirt build-up should be wiped off with a damp cloth. Cleaning should be done once per month, depending on the number and type of boxes used. If the boxes used are dirty, or if the environment in which the heads operate is dusty, cleaning on a more frequent basis may be necessary.

Cut-Off Blade

Should tape adhesive build-up occur, carefully wipe clean with oily cloth.

Blade Oiler Pad

The taping heads are equipped with a blade oiler pad that has been pre-lubricated at the factory to provide a film of oil on the cut-off blade to reduce adhesive build-up. Apply SAE #30 non-detergent oil as needed. Saturate oiler pad.

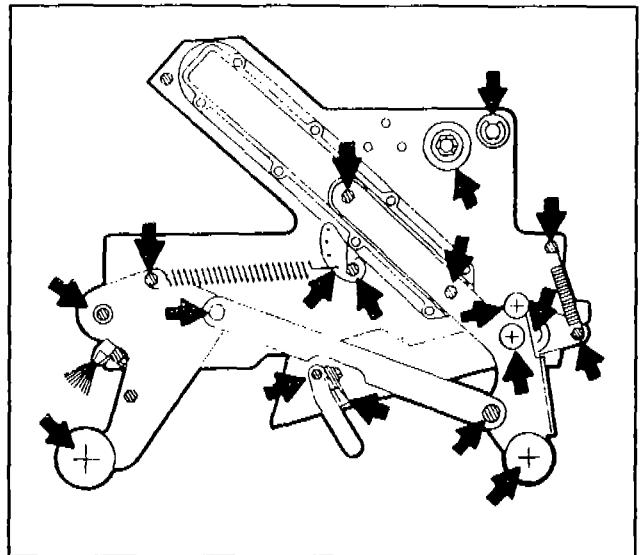

Figure 16- Lubrication Points - Upper And Lower Taping Heads

Lubrication

Like most other equipment, the taping head must be properly lubricated to insure long, trouble free service.

Figure 16 illustrates points which should be lubricated every 3 months or 150,000 machine cycles, whichever ever comes first. Lubricate the rotating and pivoting points noted by the arrows with SAE #30 non-detergent oil. At the same time, a small amount of multipurpose grease should be applied to the guides and to the end of each spring where the loop is secured at an eyelet, post, or hole.

CAUTION - WIPE OFF EXCESS OIL AND GREASE: IT WILL ATTRACT DUST AND DIRT WHICH CAN CAUSE PREMATURE EQUIPMENT WEAR AND JAMMING. TAKE CARE THAT OIL AND GREASE ARE NOT LEFT ON THE SURFACE OF ROLLERS AROUND WHICH TAPE IS THREADED, AS IT CAN CONTAMINATE THE TAPE'S ADHESIVE.

Replacement Parts And Service Information

Spare Parts

A set of spare parts that will periodically require replacement due to normal wear is supplied with the taping heads. The set includes the following which should be reordered as consumed to keep the taping heads in production:

Taping Head (Upper)

Qty.	Ref. No.	Part Number	Description
1	1146-10	78-8052-6589-5	Spring - Top Extension
1	1148-5	78-8052-6598-6	Spring - Tension
1	1148-2	78-8017-9173-8	Blade - 2.56 Inch/65 mm
2	1148-10	78-8052-6602-6	Spring - Cutter
1	-	78-8017-9433-6	Tool - Tape Threading - (Red)

Taping Head (Lower)

Qty.	Ref. No.	Part Number	Description
1	1198-11	78-8054-8550-1	Spring - Lower Extension
1	1148-5	78-8052-6598-6	Spring - Tension
1	1148-2	78-8017-9173-8	Blade - 2.56 Inch/65 mm
2	1148-10	78-8052-6602-6	Spring - Cutter
1	-	78-8017-9433-6	Tool - Tape Threading - (Red)

In addition to the above minimum spare parts, it is suggested that the following spare parts be maintained which will require replacement under normal wear of the taping head.

Qty.	Ref. No.	Part Number	Description
1	1146-5	78-8057-6178-6	Roller - Buffing
1	1145-6	78-8057-6179-4	Roller - Applying

How To Order Replacement Parts

1. Order parts by part number, part name, machine name, model number and part quantity required.

**Minimum billing on parts orders will be \$10.00.
Replacement part prices available on request.**

2. Replacement parts and part prices available direct from:

3M/Tape Dispenser Parts
241 Venture Drive
Amery, WI 54001-1325

3. Refer to the front of the instruction manual for 3M equipment service information.

**Taping Head Assemblies
Replacement Parts Illustrations and Parts Lists**

1. Refer to **Taping Head Assemblies** figure to find all the parts illustrations identified by figure numbers.
2. Refer to the figure or figures to determine the **individual parts** required and the **parts reference number**.
3. The replacement parts list, that follows each illustration, includes the **part number** and **part description** for the parts in that illustration.

Note - The complete description has been included for **standard fasteners** and some commercially available **components**. This has been done to allow obtaining these standard parts locally, should the customer elect to do so.

4. Refer to page 17 - "**Replacement Parts and Service Information**" of this manual for replacement parts ordering information.

Gen.	
Feb.	
Mar.	
Apr.	
Mag.	
Jun.	
Jul.	
Aug.	
Sep.	
Oct.	
Nov.	
Dec.	
1987	
1988	
1989	
1990	
1991	
1992	

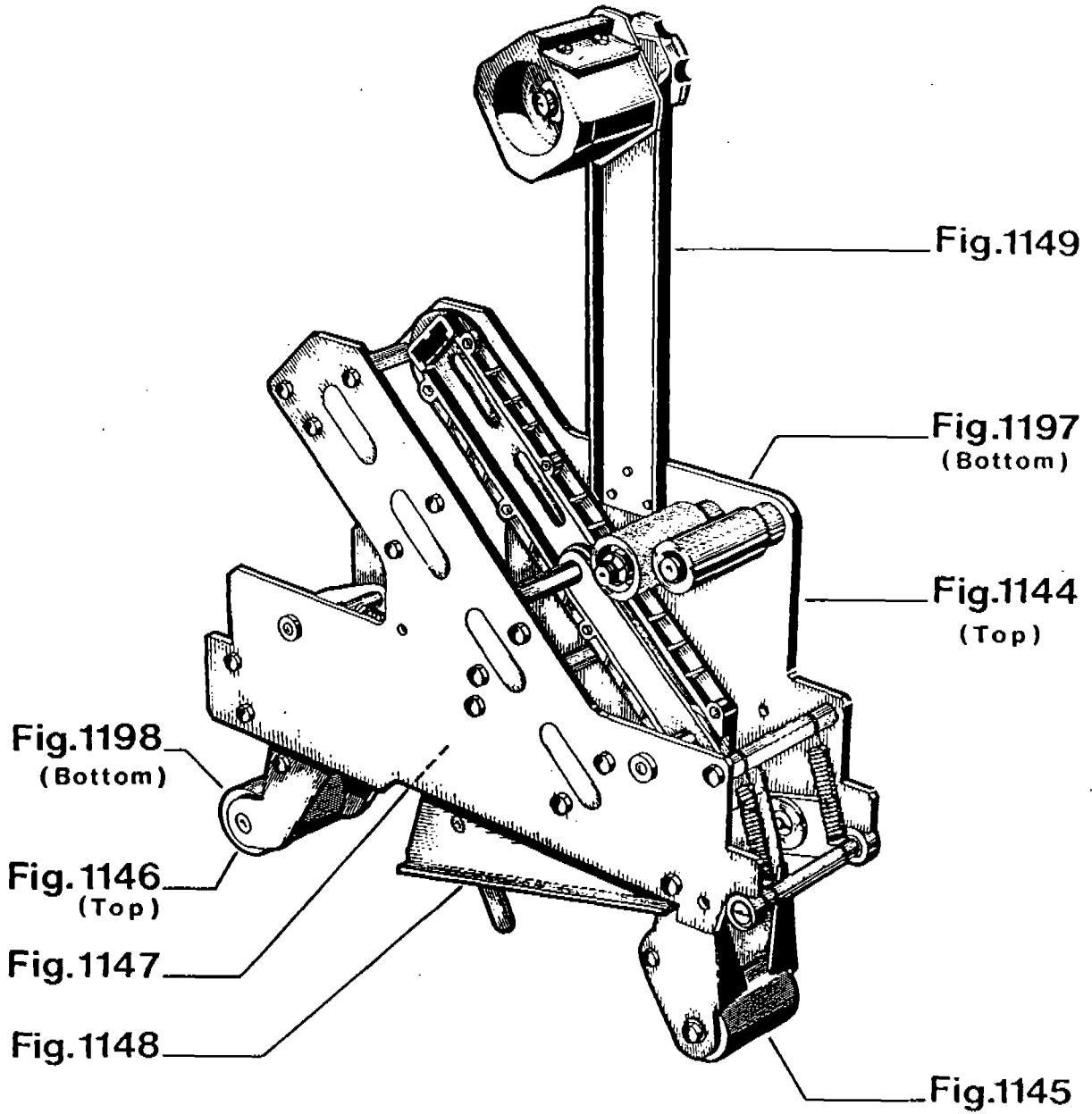

K9-3M

Figura	Descrizione	Figura	Cod.Mag.	Codice Sec.	Descrizione
1144,00			000000	00000000K9T	ACCUGLIDE HEAD 2" K9 TOP

Posizione	Cod.Ric.Sec.	Descrizione	U.M.	Quantita'
1,0	78805265564	FRAME - R/H TOP	PZ	1,000
2,0	78805265572	FRAME - L/H TOP	PZ	1,000
3,0	78805265580	SPACER-SPRING HOOK	PZ	1,000
4,0	78805265598	SPACER - UPPER	PZ	1,000
5,0	78805265606	SPACER - FRONT	PZ	1,000
10,0	78805265648	SHAFT - TENSION ROLLER	PZ	1,000
11,0	78805265655	ROLLER - TOP TENSION	PZ	1,000
12,0	78805265663	WASHER - FRICTION	PZ	2,000
13,0	78801790771	NUT - SELF-LOCKING M10X1	PZ	1,000
14,0	78805265671	SPRING - COMPRESSION	PZ	1,000
15,0	78805265689	SHAFT - WRAP ROLLER	PZ	1,000
16,0	78805265697	ROLLER - WRAP	PZ	1,000
17,0	26100016133	RING - RETAINING 10DING799	PZ	1,000
18,0	26100358295	SCREW - HEX.HD. M6X12	PZ	10,000
19,0	78805265705	GUIDE	PZ	2,000
20,0	83000273363	SCREW - HEX HD M4X14 ZINC.PL	PZ	16,000
21,0	78801074168	NUT-METRIC, HEX, STEEL M4	PZ	16,000
23,0	26100000103	WASHER - FLAT M6	PZ	1,000
24,0	78806079360	BRUSH ASSY	PZ	1,000

=====
===== Data 13/05/91 =

Gen
Feb
Mar
Apr
May
Jun
Jul
Aug
Sep
Oct
Nov
Dec
1987
1988
1989
1990
1991
1992

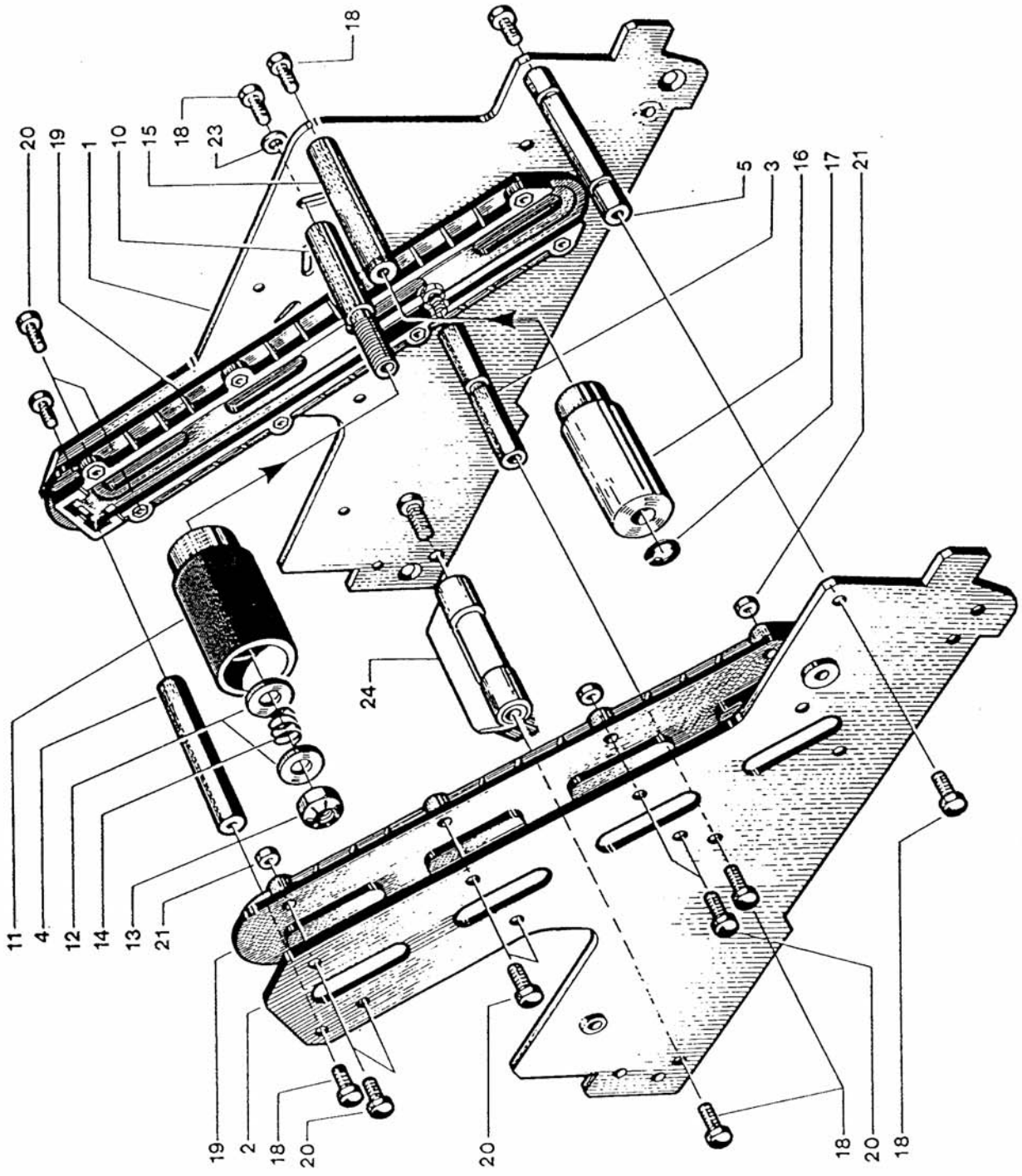

K9-3M

TOP

Fig. 1144

figura	Descrizione figura	Cod.Mag.	Codice Sec.	Descrizione
1145,00		000000	00000000K9T	ACCU SLIDE HEAD 2" K9 TOP

posizione	Cod.Ric.Sec.	Descrizione	U.M.	Quantita'
1,0	78805265721	FRAME - APPLYING R/H	PZ	1,000
2,0	78805265739	FRAME - APPLYING L/H	PZ	1,000
3,0	78805265747	PLATE - BACK UP	PZ	1,000
4,0	78805265754	SHAFT - ROLLER	PZ	3,000
6,0	78805761794	ROLLER - APPLYING NM	PZ	1,000
8,0	78805265796	ROLLER - WRAP	PZ	1,000
9,0	78805265804	SPACER - REAR	PZ	2,000
10,0	78801790821	BEARING-SPECIAL 30MM	PZ	4,000
11,0	78801791068	SCREW-BEARING SHOULDER	PZ	4,000
12,0	26100358295	SCREW - HEX.HD. M6X12	PZ	4,000
13,0	26100547590	SCREW - FLAT HD M6X12 ZINC.PL	PZ	2,000
14,0	78805265663	WASHER - FRICTION	PZ	2,000
15,0	78805265671	SPRING - COMPRESSION	PZ	1,000
16,0	78806079428	ROLLER - KNURLED	PZ	1,000
17,0	78801790748	WASHER-NYLON 15MM	PZ	1,000
18,0	78806083958	BUSHING-APPLYING ROLLER	PZ	1,000

===== Data 13/05/91 =

Gen.	
Feb.	
Mar.	
Apr.	
Mag.	
Giun.	
Lug.	
Ago.	
Set.	
Ott.	
Nov.	
Dic.	
1987	
1988	
1989	
1990	
1991	
1992	

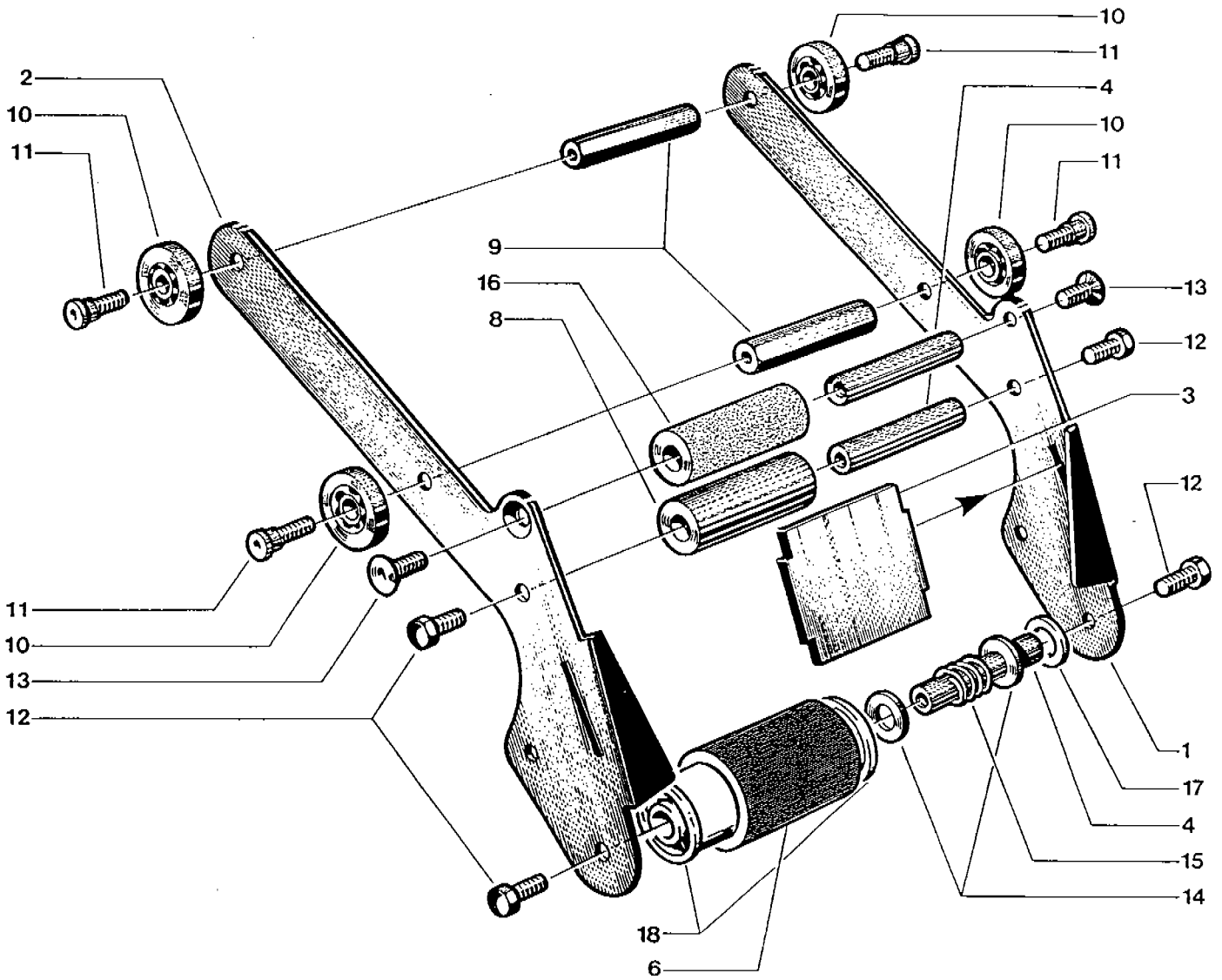

K9-3M

Fig. 1145

Figura	Descrizione Figura	Cod.Mag.	Codice Sec.	Descrizione
1146,00		000000	00000000K9T	ACCUGLIDE HEAD 2" K9 TOP

Posizione	Cod.Ric.Sec.	Descrizione	U.M.	Quantita'
1,0	78805265838	FRAME - R/H 4501989	PZ	1,000
2,0	78805265846	FRAME - L/H 4501989	PZ	1,000
3,0	78805265754	SHAFT - ROLLER	PZ	1,000
4,0	78805265861	BUSHING - BUFFING ROLLER	PZ	1,000
5,0	78805761786	ROLLER - BUFFING NM	PZ	1,000
6,0	78805265879	SPACER - SPRING	PZ	1,000
7,0	78801791092	SHAFT-10X90MM	PZ	1,000
8,0	26100358295	SCREW - HEX.HD. M6X12	PZ	4,000
9,0	26100547590	SCREW - FLAT HD M6X12 ZINC.PL	PZ	2,000
10,0	78805265895	SPRING - TOP EXT	PZ	1,000
12,0	78805265903	HOLDER-SPRING	PZ	1,000

=====
 ===== Data 13/05/91 =

Gen.	
Feb.	
Mar.	
Apr.	
May	
Jun.	
Jul.	
Aug.	
Sep.	
Oct.	
Nov.	
Dec.	
1987	
1988	
1989	
1990	
1991	
1992	

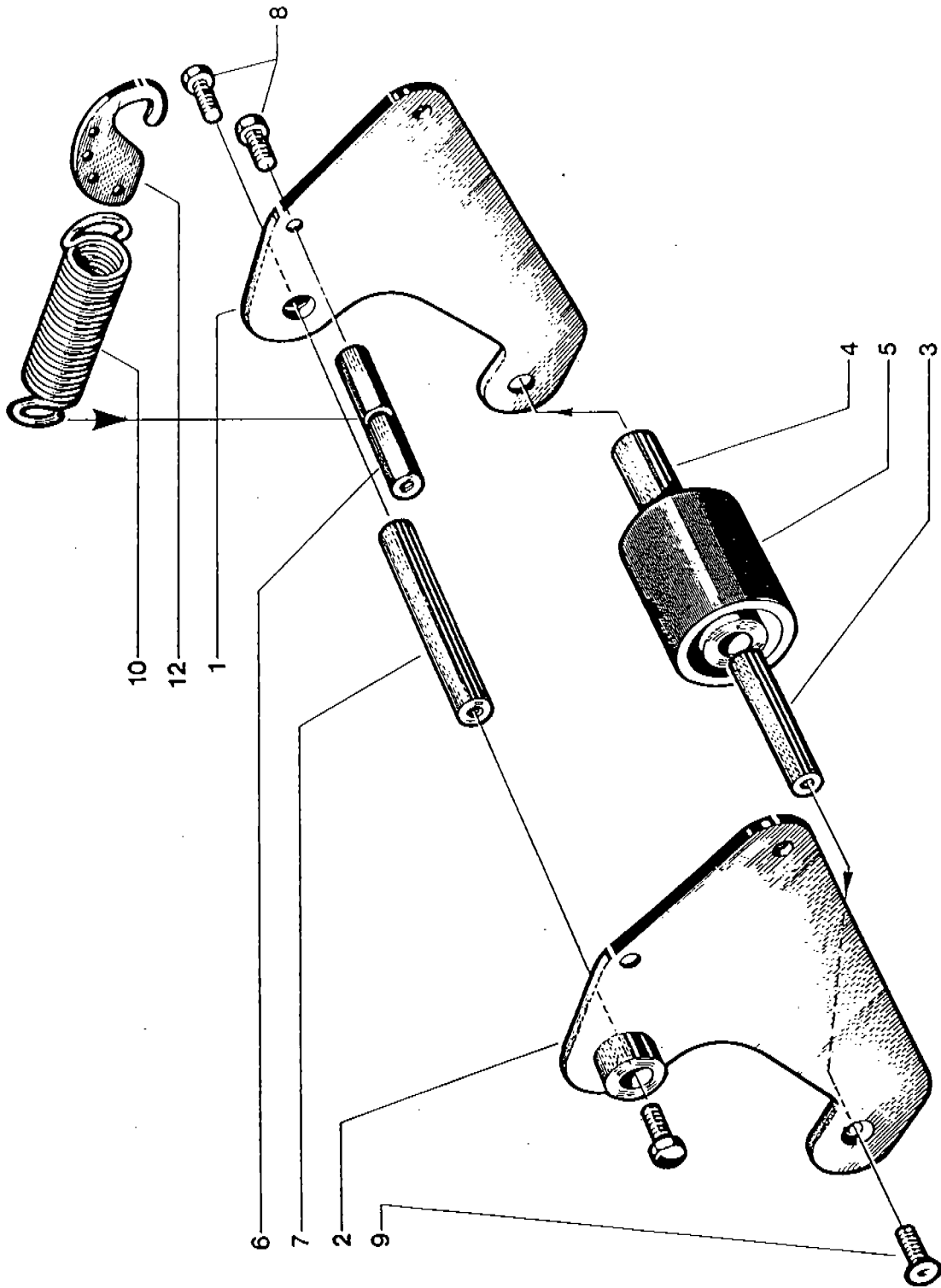

K9-3M

TOP

Fig. 1146

Figura	Descrizione	Figura	Cod.Mag.	Codice Sec.	Descrizione
1147,00			000000	00000000K9T	ACCUGLIDE HEAD 2" K9 TOP

Posizione	Cod.Ric.Sec.	Descrizione	U.M.	Quantita'
1,0	78805265929	ARM -LINK	PZ	2,000
2,0	78805265937	SHAFT - PIVOT	PZ	1,000
3,0	78805265945	BUSHING - PIVOT	PZ	2,000
4,0	78801071636	SCREW-METRIC, MSX10, HEX.HD.	PZ	4,000

=====
 ===== Data 13/05/91 =

Grn
 Feb
 Mar
 Apr
 May
 Jun
 Jul
 Aug
 Sep
 Oct
 Nov
 Dec
 1987
 1988
 1989
 1990
 1991
 1992

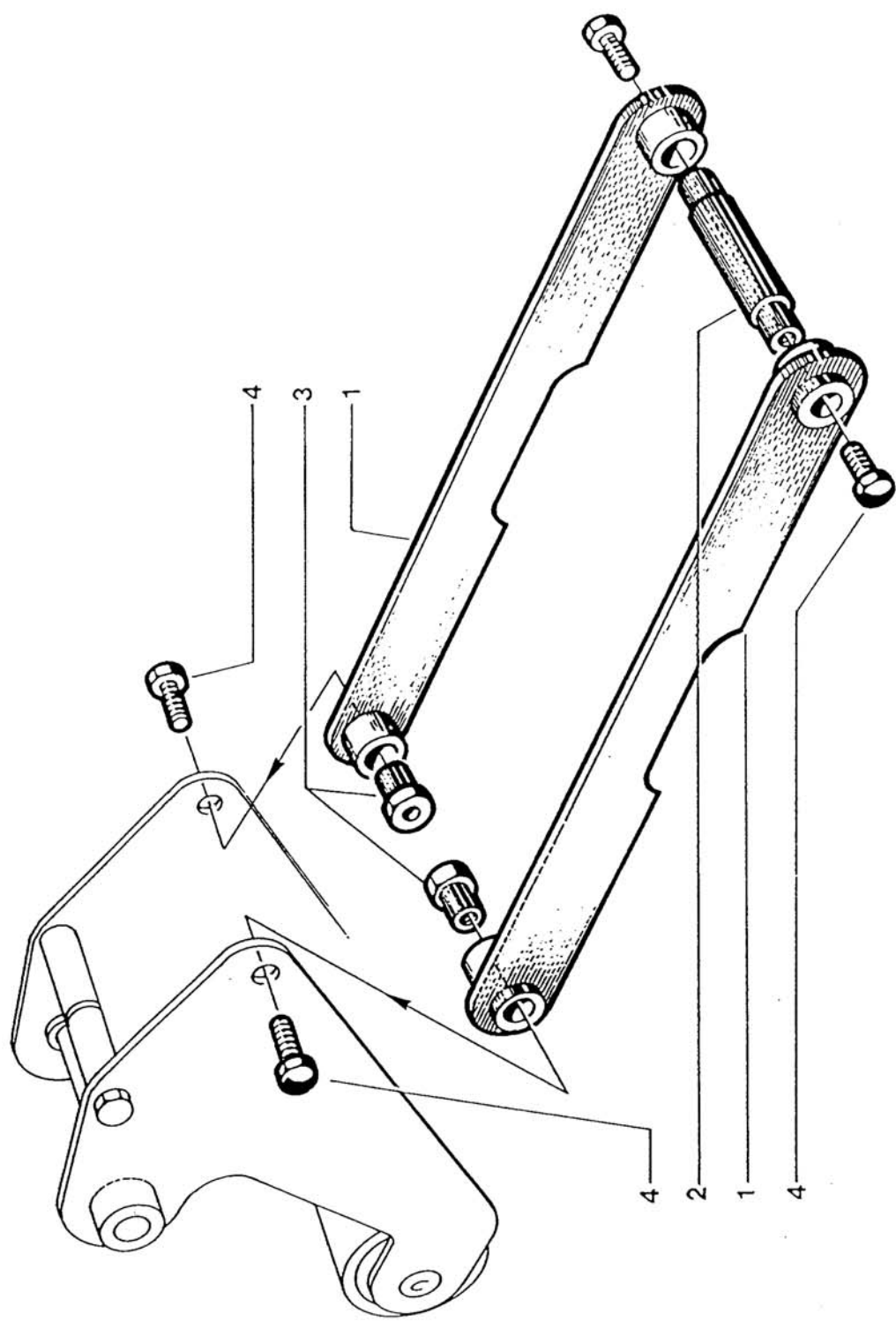

K9-3M

Fig. 1147

Figura	Descrizione Figura	Cod.Mag.	Codice Sec.	Descrizione
1148,00		000000	00000000K9T	ACCUGLIDE HEAD 2" K9 TOP

Posizione	Cod.Ric.Sec.	Descrizione	U.M.	Quantita'
1,0	78806081671	BRACKET - CUT OFF	PZ	1,000
2,0	78801791738	BLADE - 2,56 IN.(65 MM.)	PZ	1,000
3,0	78805265960	GUARD - BLADE	PZ	1,000
4,0	78805265978	SHAFT - BLADE GUARD	PZ	1,000
5,0	78806238842	SPRING - TENSION	PZ	1,000
6,0	78801791357	SHAFT - SPACER	PZ	1,000
7,0	78805266000	SPACER	PZ	2,000
8,0	78801791332	BUMPER	PZ	2,000
9,0	78801791324	PIVOT-CUTTER LEVER	PZ	2,000
10,0	78805266026	SPRING - CUTTER	PZ	2,000
11,0	26100358295	SCREW - HEX.HD. M6X12	PZ	2,000
12,0	26100547582	SCREW - FLAT HD M5X20 ZINC.PL	PZ	2,000
15,0	26100547574	SCREW - FLAT HD M4X10 ZINC.PL	PZ	2,000
16,0	26100258172	SCREW - HEX HD M5X8 ZINC.PL	PZ	3,000
17,0	78800557411	WASHER-METRIC, PLAIN, M5	PZ	3,000

=====
 ===== Data 13/05/91 =

Gen.	
Feb.	
Mar.	
Apr.	
May	
Jun	
Jul	
Aug.	
Sep.	
Oct.	
Nov.	
Dec.	
1987	
1988	
1989	
1990	
1991	
1992	

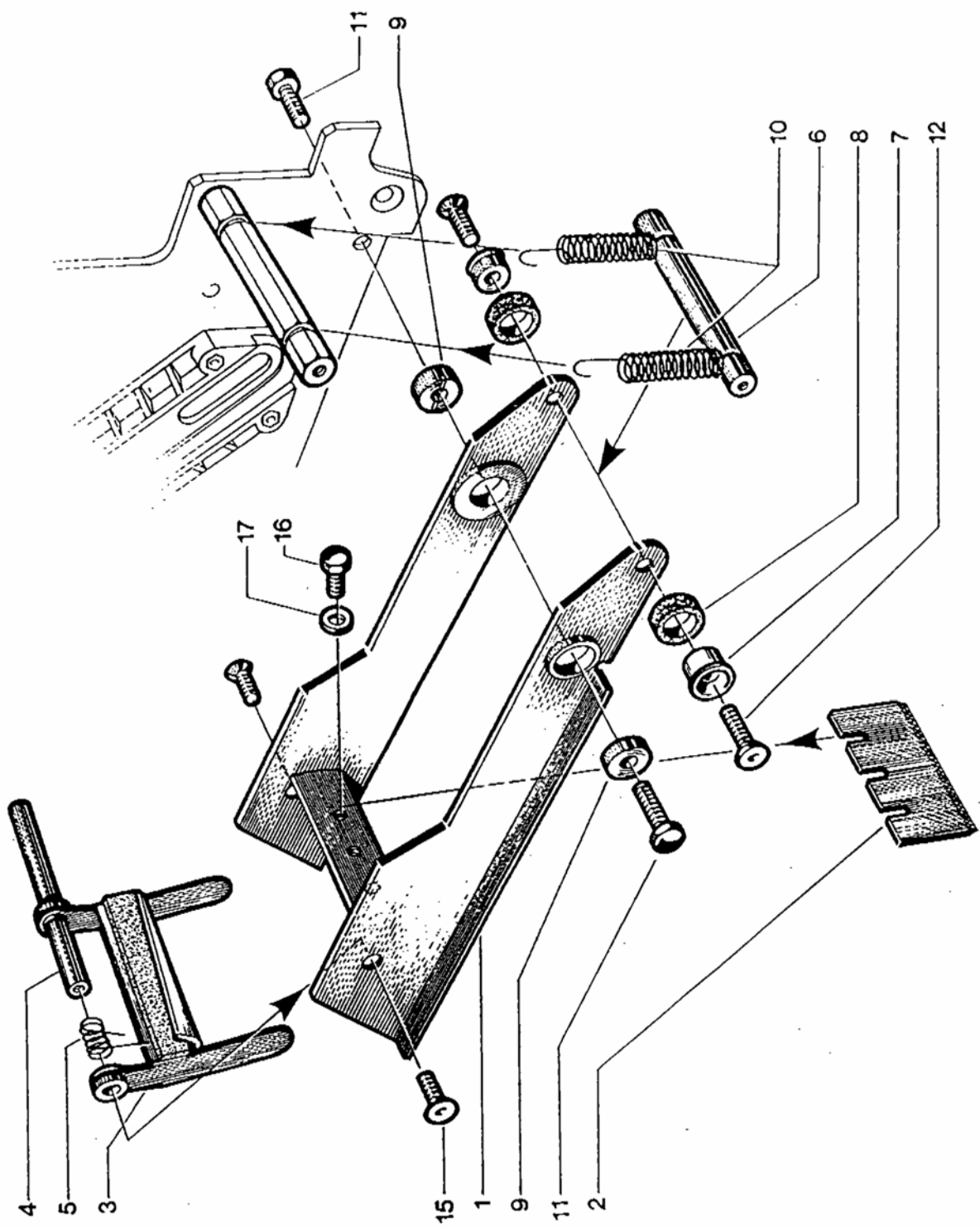

K9-3M

Fig. 1148

Figura	Descrizione	Figura	Cod.Mag.	Codice Sec.	Descrizione
1149,00			000000	00000000K9T	ACCUGLIDE HEAD 2" K9 TOP

Posizione	Cod.Ric.Sec.	Descrizione	U.M.	Quantita'
1,0	78805265440	BRACKET - TAPE DRUM	PZ	1,000
2,0	78801790912	PLATE-LOCKING, TAPE DRUM SHAFT	PZ	1,000
3,0	78805266034	SHAFT - TAPE DRUM	PZ	1,000
4,0	78805267495	TAPE DRUM ASSEMBLY	PZ	1,000
5,0	78805262686	LEAF SPRING	PZ	1,000
6,0	26100257539	SCREW-SELF TAPPING	PZ	2,000
7,0	78805265416	WASHER - SPECIAL	PZ	1,000
8,0	26100261101	RING-RETAINING FOR 14MM SHAFT	PZ	1,000
9,0	26100358295	SCREW - HEX.HD. M6X12	PZ	3,000
10,0	26100000103	WASHER - FLAT M6	PZ	3,000
11,0	78807015694	TAPE DRUM ASSY - 2" WIDE	PZ	1,000

=====
 ===== Data 13/05/91 =

Gen
Feb
Mar
Apr
May
Jun
Jul
Aug
Sep
Oct
Nov
Dec
1987
1988
1989
1990
1991
1992

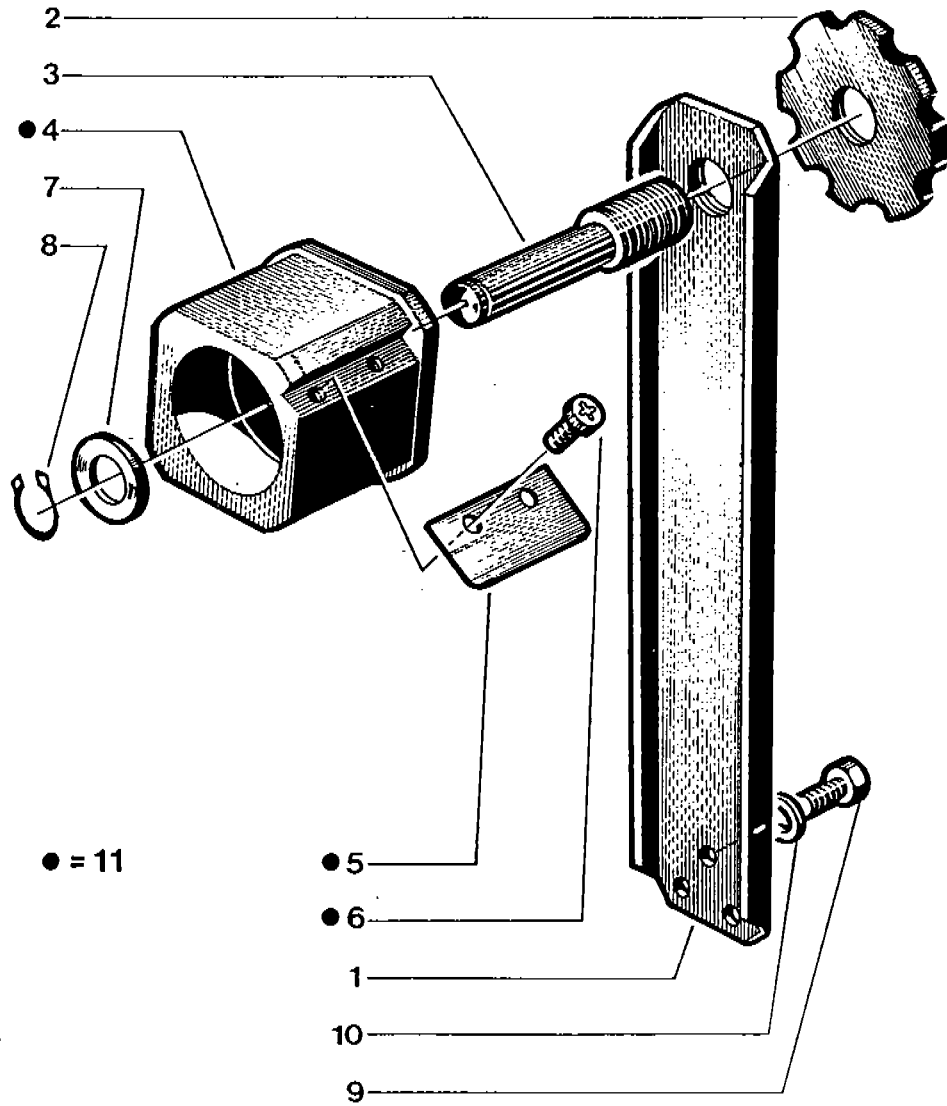

K9-3M

Fig. 1149

Figura	Descrizione Figura	Cod.Mag.	Codice Sec.	Descrizione
1145,00		000000	00000000K9B	ACCUGLIDE HEAD 2" K9 BOTTOM

Quantita'	Cod.Ric.Sec.	Descrizione	U.M.	Quantita'
1,0	78805265721	FRAME - APPLYING R/H.	PZ	1,000
2,0	78805265739	FRAME - APPLYING L/H	PZ	1,000
3,0	78805265747	PLATE - BACK UP	PZ	1,000
4,0	78805265754	SHAFT - ROLLER	PZ	3,000
6,0	78805761794	ROLLER - APPLYING NM	PZ	1,000
8,0	78805265796	ROLLER - WRAP	PZ	1,000
9,0	78805265804	SPACER - REAR	PZ	2,000
10,0	78801790821	BEARING-SPECIAL 30MM	PZ	4,000
11,0	78801791068	SCREW-BEARING SHOULDER	PZ	4,000
12,0	26100358295	SCREW - HEX.HD. M6X12	PZ	4,000
13,0	26100547590	SCREW - FLAT HD M6X12 ZINC.PL	PZ	2,000
14,0	78805265663	WASHER - FRICTION	PZ	2,000
15,0	78805265671	SPRING - COMPRESSION	PZ	1,000
16,0	78806079428	ROLLER - KNURLED	PZ	1,000
17,0	78801790749	WASHER-NYLON 15MM	PZ	1,000
18,0	78806083958	BUSHING-APPLYING ROLLER	PZ	1,000

==== Data 13/05/91 =

Gen
Feb
Mar
Apr
May
Jun
Jul
Aug
Sep
Oct
Nov
Dec
1987
1988
1989
1990
1991
1992

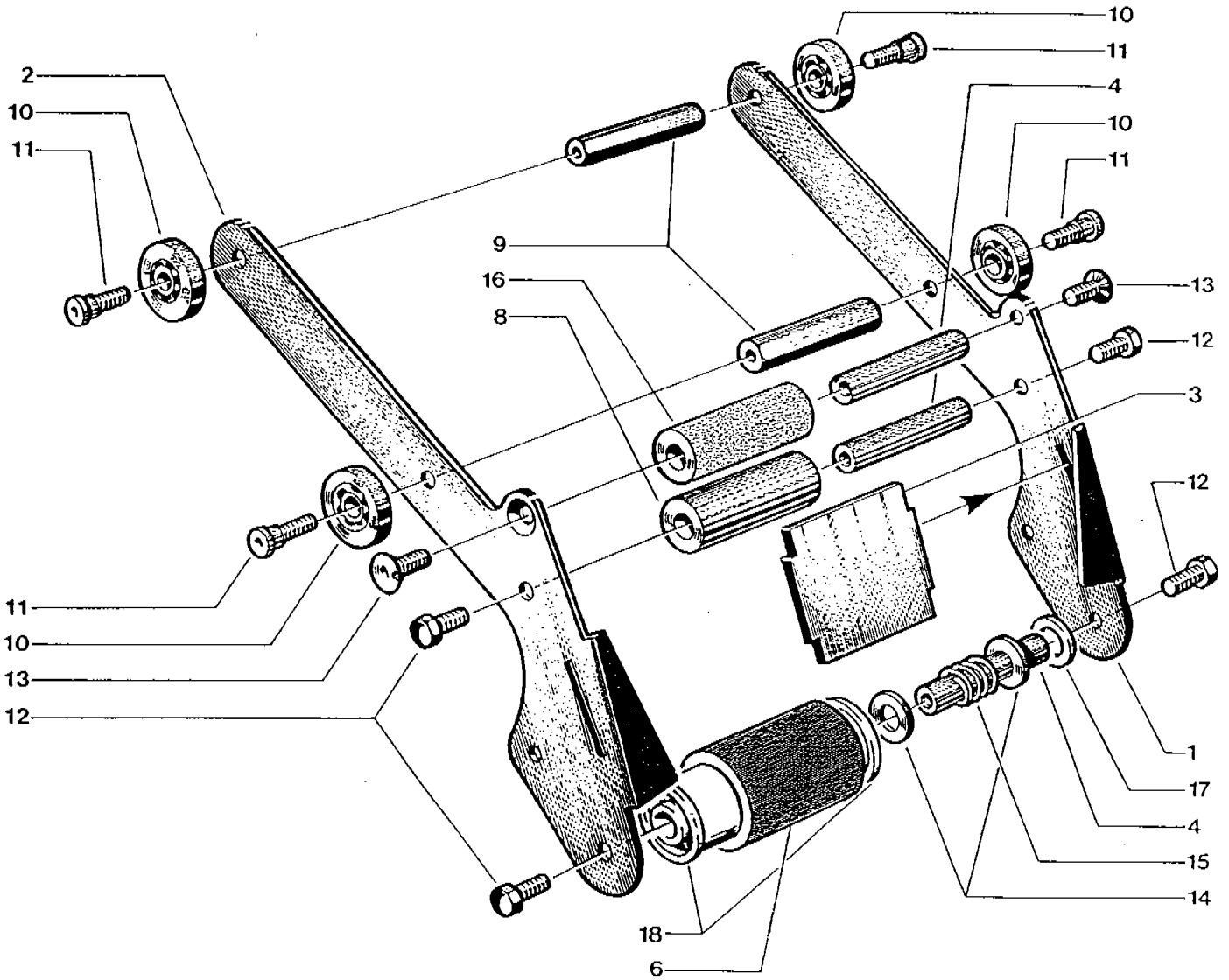

K9-3M

Fig. 1145

Figura	Descrizione	Figura	Cod.Mag.	Codice Sec.	Descrizione
1147,00			000000	00000000K9B	ACCUGLIDE HEAD 2" K9 BOTTOM

Posizione	Cod.Ric.Sec.	Descrizione	U.M.	Quantita'
1,0	78805265929	ARM -LINK	PZ	2,000
2,0	78805265937	SHAFT - PIVOT	PZ	1,000
3,0	78805265945	BUSHING - PIVOT	PZ	2,000
4,0	78801071636	SCREW-METRIC, M5X10, HEX.HD.	PZ	4,000

=====
 ===== Data 13/05/91 =

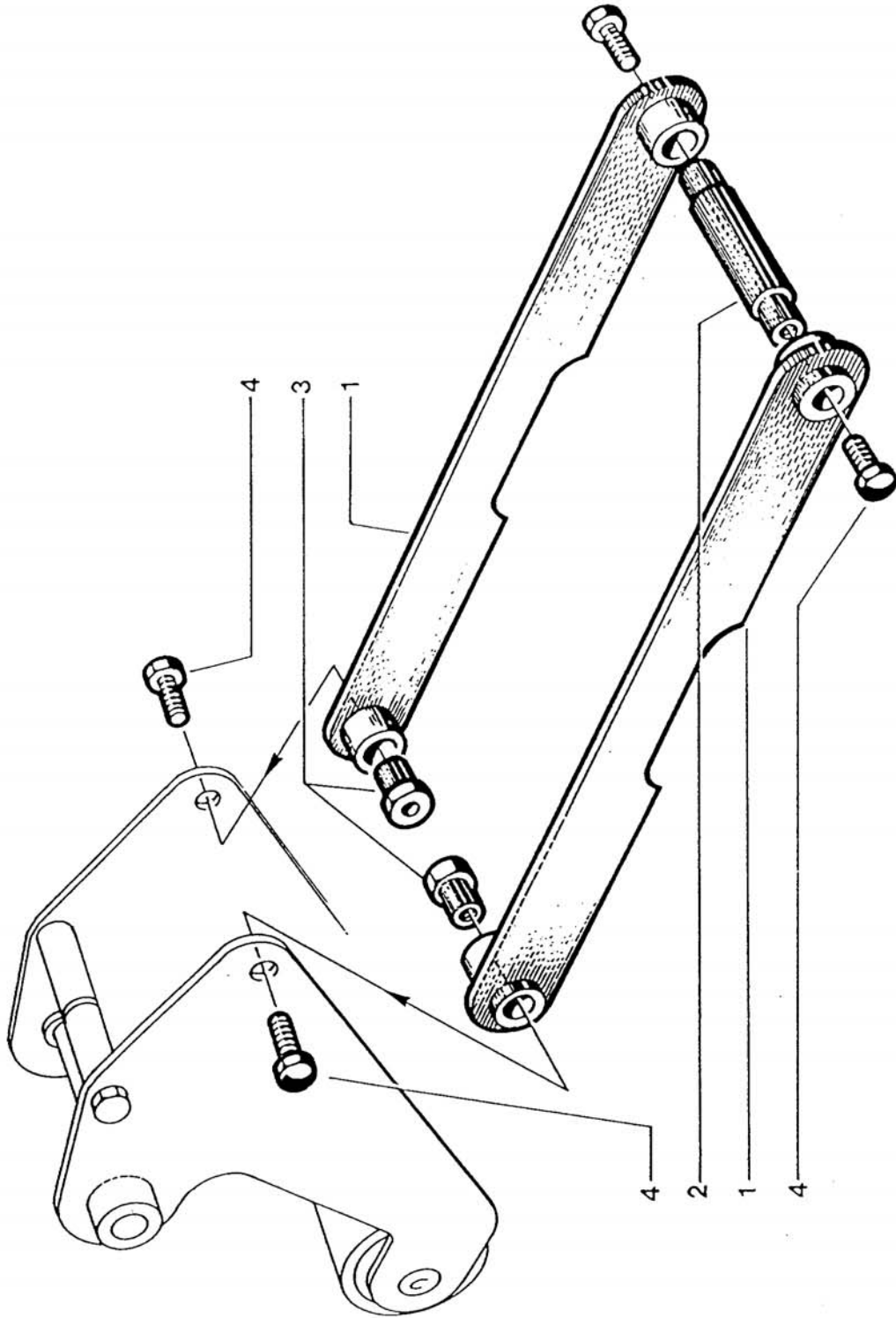

K9-3M

Fig. 1147

Figura	Descrizione	Figura	Cod.Mag.	Codice Sec.	Descrizione
1148,00			000000	00000000K9B	ACCU6LIDE HEAD 2" K9 BOTTOM

Posizione	Cod.Ric.Sec.	Descrizione	U.M.	Quantita'
1,0	78806081671	BRACKET - CUT OFF	PZ	1,000
2,0	78801791738	BLADE - 2,56 IN.(65 MM.)	PZ	1,000
3,0	78805265960	GUARD - BLADE	PZ	1,000
4,0	78805265978	SHAFT - BLADE GUARD	PZ	1,000
5,0	78806238842	SPRING - TENSION	PZ	1,000
6,0	78801791357	SHAFT - SPACER	PZ	1,000
7,0	78805266000	SPACER	PZ	2,000
8,0	78801791332	BUMPER	PZ	2,000
9,0	78801791324	PIVOT-CUTTER LEVER	PZ	2,000
10,0	78805266026	SPRING - CUTTER	PZ	2,000
11,0	26100358295	SCREW - HEX.HD. M6X12	PZ	2,000
12,0	26100547582	SCREW - FLAT HD M5X20 ZINC.PL	PZ	2,000
15,0	26100547574	SCREW - FLAT HD M4X10 ZINC.PL	PZ	2,000
16,0	26100258172	SCREW - HEX HD M5X8 ZINC.PL	PZ	3,000
17,0	78800557411	WASHER-METRIC, PLAIN, M5	PZ	3,000

==== Data 13/05/91 =

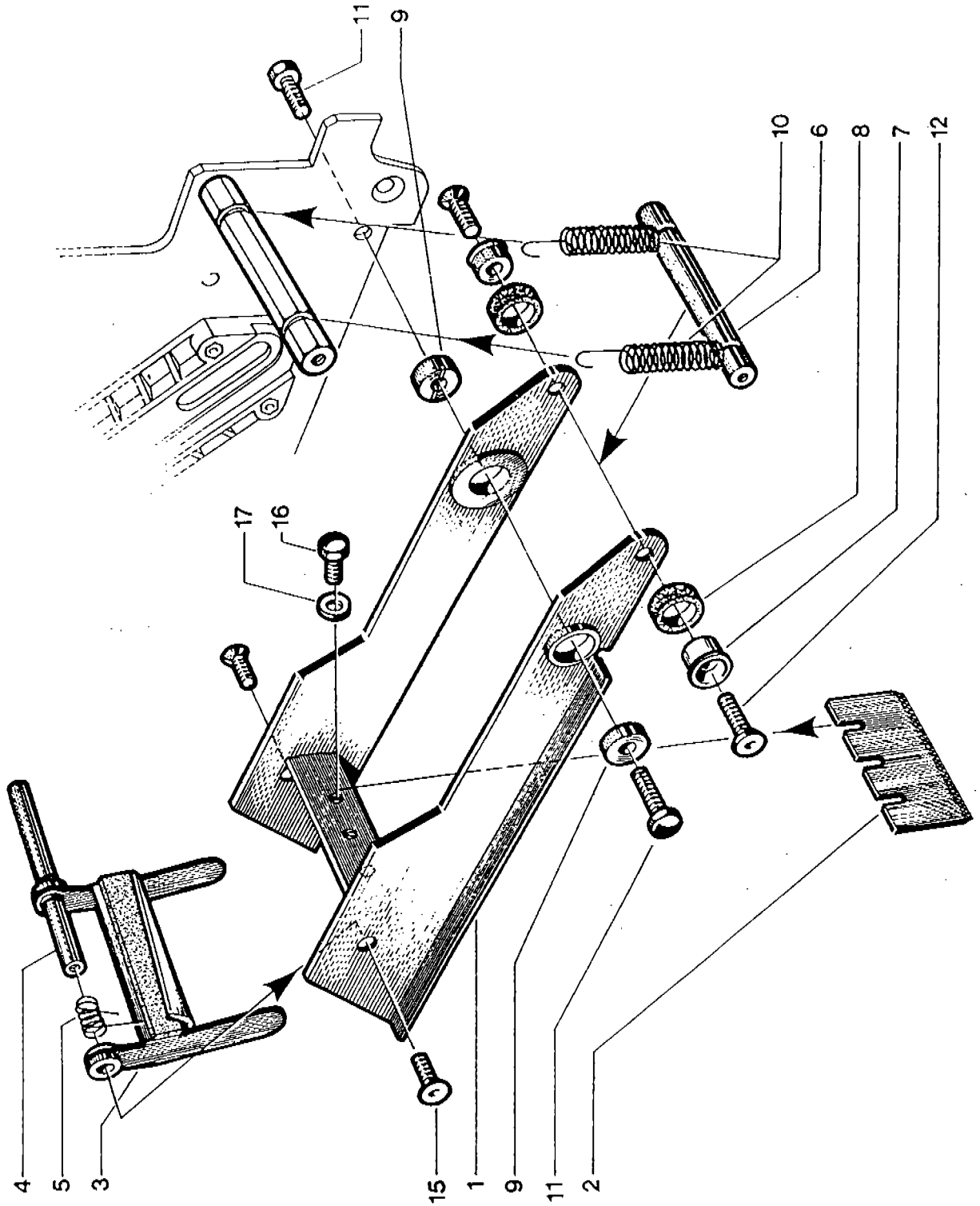

K9-3M

Fig. 1148

Figura	Descrizione	Figura	Cod.Mag.	Codice Sec.	Descrizione
1149,00			000000	00000000K9B	ACCUGLIDE HEAD 2" K9 BOTTOM

Posizione	Cod.Ric.Sec.	Descrizione	U.M.	Quantita'
1,0	78805265440	BRACKET - TAPE DRUM	PZ	1,000
2,0	78801790912	PLATE-LOCKING, TAPE DRUM SHAFT	PZ	1,000
3,0	78805266034	SHAFT - TAPE DRUM	PZ	1,000
4,0	78805267495	TAPE DRUM ASSEMBLY	PZ	1,000
5,0	78805262686	LEAF SPRING	PZ	1,000
6,0	26100257539	SCREW-SELF TAPPING	PZ	2,000
7,0	78805265416	WASHER - SPECIAL	PZ	1,000
8,0	26100261101	RING-RETAINING FOR 14MM SHAFT	PZ	1,000
9,0	26100358295	SCREW - HEX.HD. M6X12	PZ	3,000
10,0	26100000103	WASHER - FLAT M6	PZ	3,000
11,0	78807015694	TAPE DRUM ASSY - 2" WIDE	PZ	1,000

=====
 ===== Data 13/05/91 =

Gen.	
Feb.	
Mar.	
Apr.	
Mag.	
Giù.	
Lug.	
Agò.	
Set.	
Ott.	
Nov.	
Dic.	
1987	
1988	
1989	
1990	
1991	
1992	

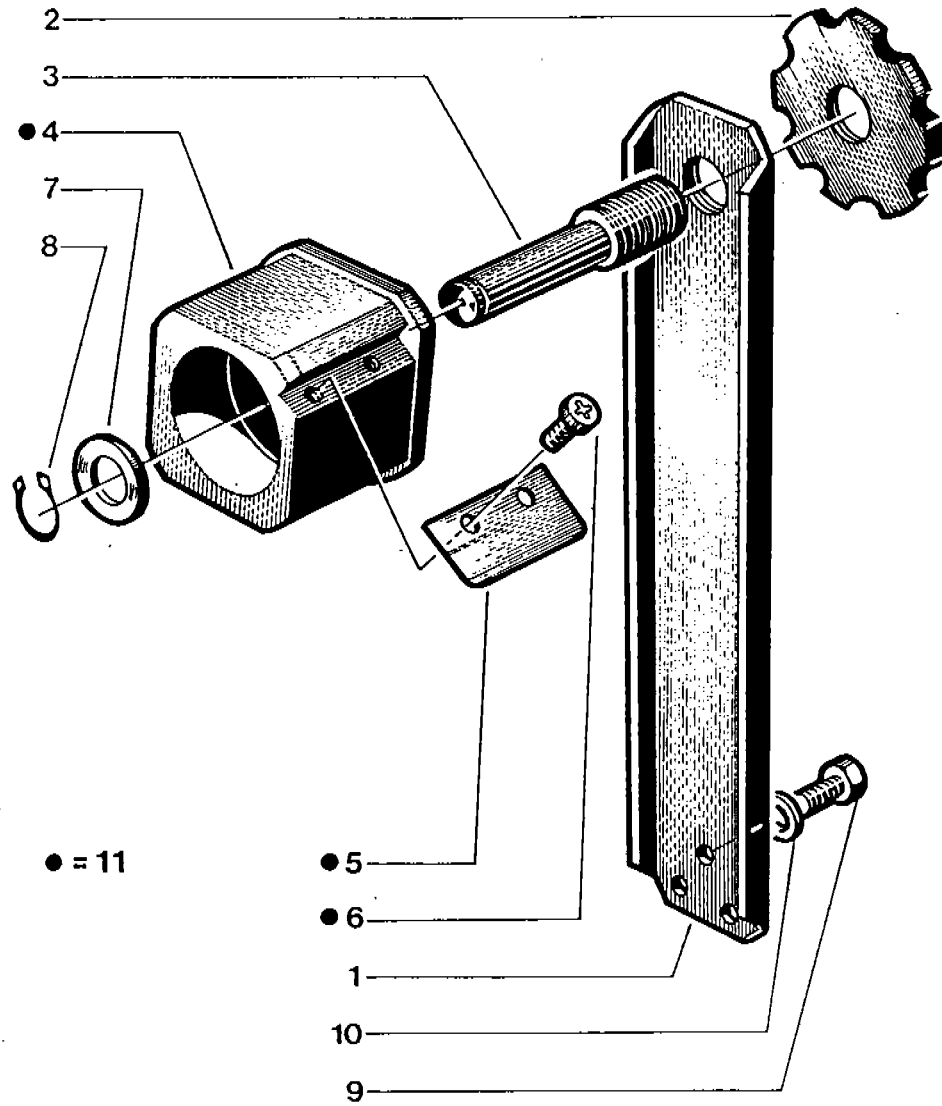

K9-3M

Fig. 1149

Figura	Descrizione	Figura	Cod.Mag.	Codice Sec.	Descrizione
1197,00			000000	00000000K9B	ACCUGLIDE HEAD 2" K9 BOTTOM

Posizione	Cod.Ric.Sec.	Descrizione	U.M.	Quantita'
3,0	78805265580	SPACER-SPRING HOOK	PZ	1,000
4,0	78805265598	SPACER - UPPER	PZ	1,000
5,0	78805265606	SPACER - FRONT	PZ	1,000
10,0	78805265648	SHAFT - TENSION ROLLER	PZ	1,000
12,0	78805265663	WASHER - FRICTION	PZ	2,000
13,0	78801790771	NUT - SELF-LOCKING M10X1	PZ	1,000
14,0	78805265671	SPRING - COMPRESSION	PZ	1,000
15,0	78805265689	SHAFT - WRAP ROLLER	PZ	1,000
16,0	78805265697	ROLLER - WRAP	PZ	1,000
17,0	26100016133	RING - RETAINING 10DIN6799	PZ	1,000
18,0	26100358295	SCREW - HEX.HD. M6X12	PZ	10,000
19,0	78805265705	GUIDE	PZ	2,000
20,0	83000273363	SCREW - HEX HD M4X14 ZINC.PL	PZ	16,000
21,0	78801074168	NUT-METRIC, HEX, STEEL M4	PZ	16,000
23,0	78805266042	FRAME - L/H BOTTOM	PZ	1,000
24,0	78805266059	FRAME - R/H BOTTOM	PZ	1,000
25,0	78805266067	ROLLER - TENSION BOTTOM	PZ	1,000
26,0	26100000103	WASHER - FLAT M6	PZ	1,000
27,0	78806079360	BRUSH ASSY	PZ	1,000

=====
 ===== Data 13/05/91 =

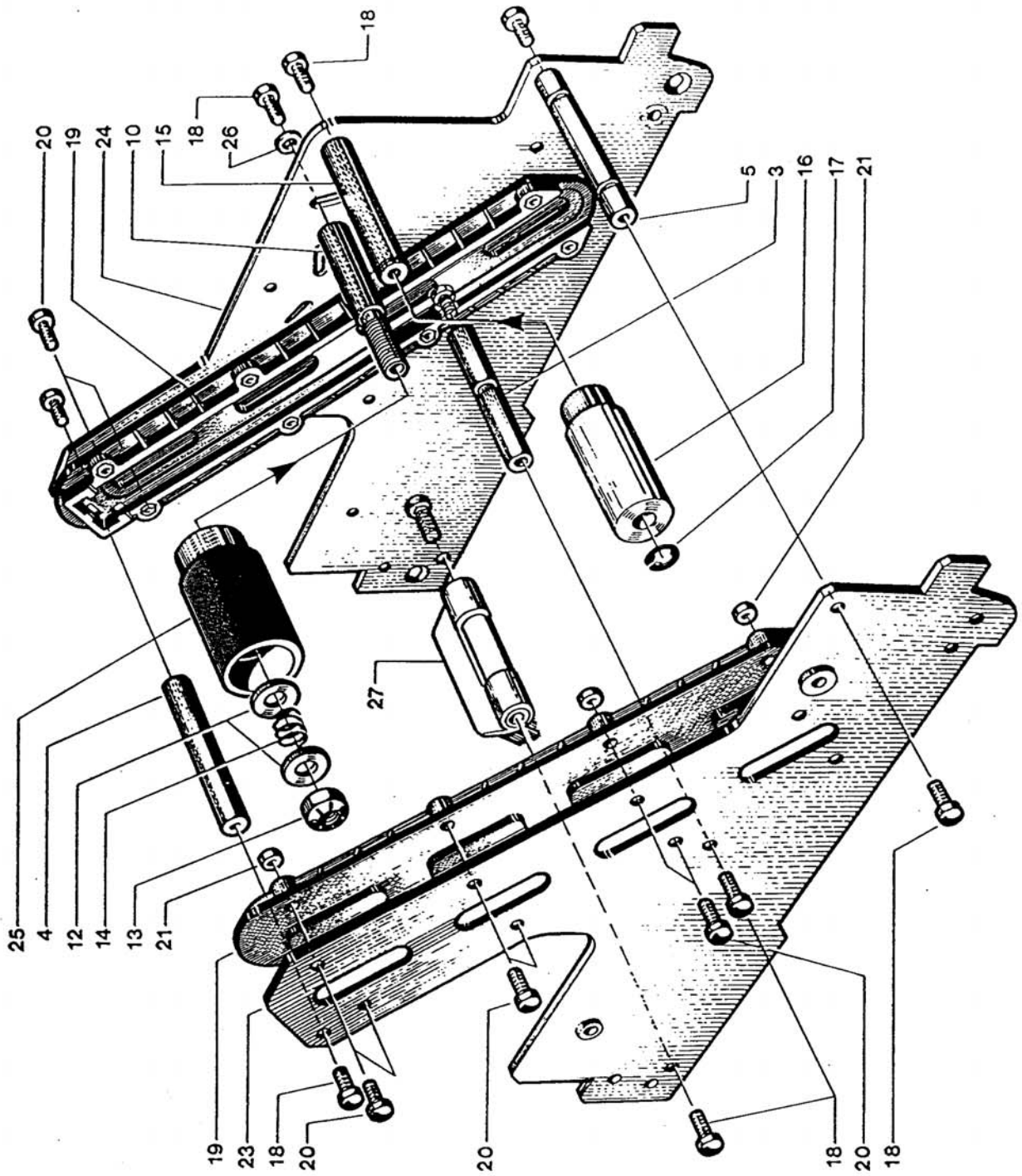

K9-3M

BOTTOM

Fig. 1197

Figura	Descrizione Figura	Cod.Mag.	Codice Sec.	Descrizione
1198,00		000000	00000000K9B	ACCUGLIDE HEAD 2" K9 BOTTOM

Posizione	Cod.Ric.Sec.	Descrizione	U.M.	Quantita'
1,0	78805265838	FRAME - R/H	PZ	1,000
2,0	78805265846	FRAME - L/H	PZ	1,000
3,0	78805265754	SHAFT - ROLLER	PZ	1,000
4,0	78805265861	BUSHING - BUFFING ROLLER	PZ	1,000
5,0	78805761786	ROLLER - BUFFING MM	PZ	1,000
6,0	78805265879	SPACER - SPRING	PZ	1,000
7,0	78801791092	SHAFT-10X90MM	PZ	1,000
8,0	26100358295	SCREW - HEX.HD. M6X12	PZ	4,000
9,0	26100547590	SCREW - FLAT HD M6X12 ZINC.PL	PZ	2,000
11,0	78805485501	MAIN SPRING - BOTTOM HEAD	PZ	1,000
12,0	78805265903	HOLDER-SPRING	PZ	1,000

=====
 ===== Data 13/05/91 =

Gen	
Feb	
Mar	
Apr	
May	
Jun	
Jul	
Aug	
Sep	
Oct	
Nov	
Dec	
1987	
1988	
1989	
1990	
1991	
1992	

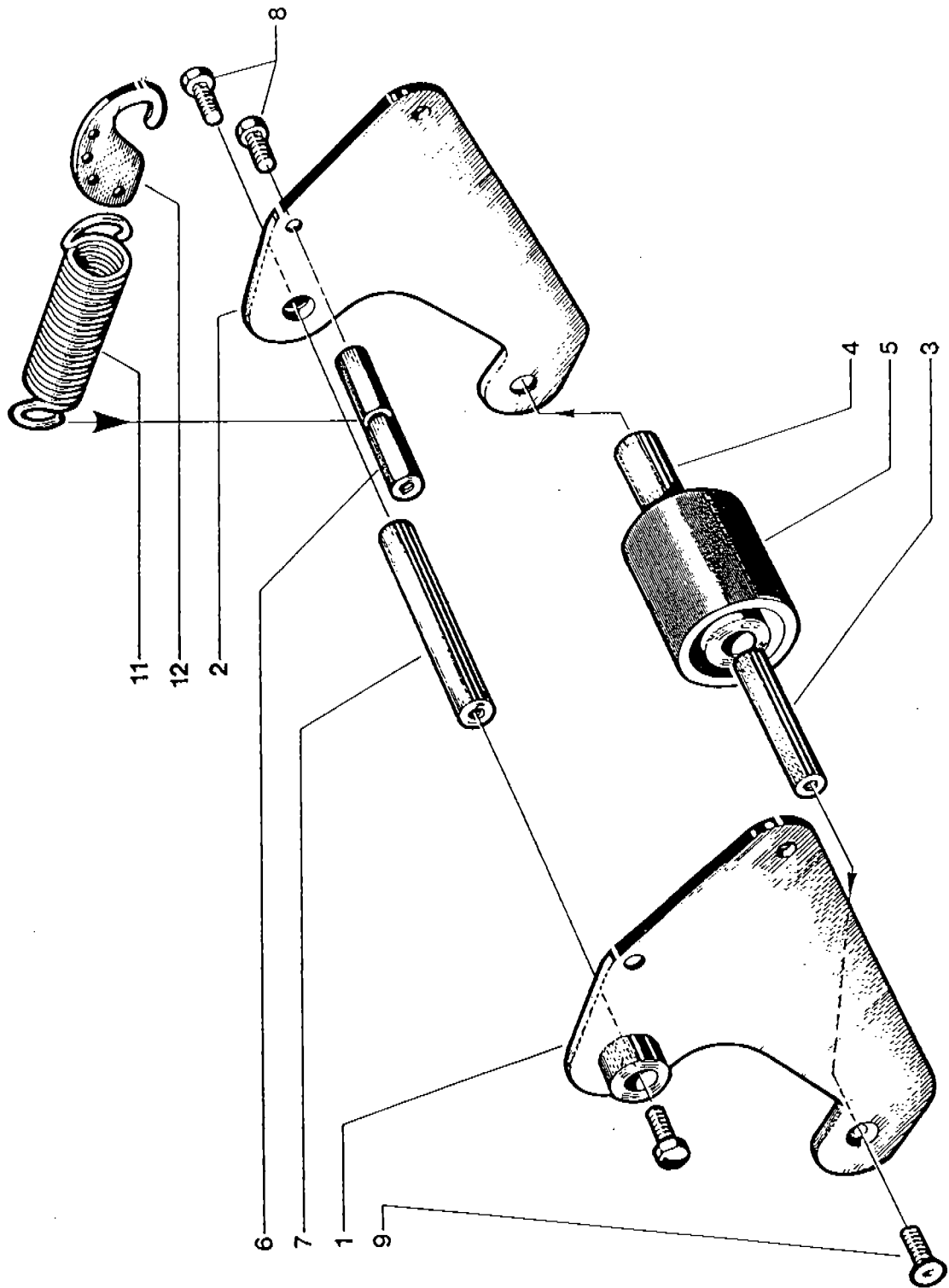

K9-3M **BOTTOM**

Fig. 1198